

STEEL WIRE ROPE

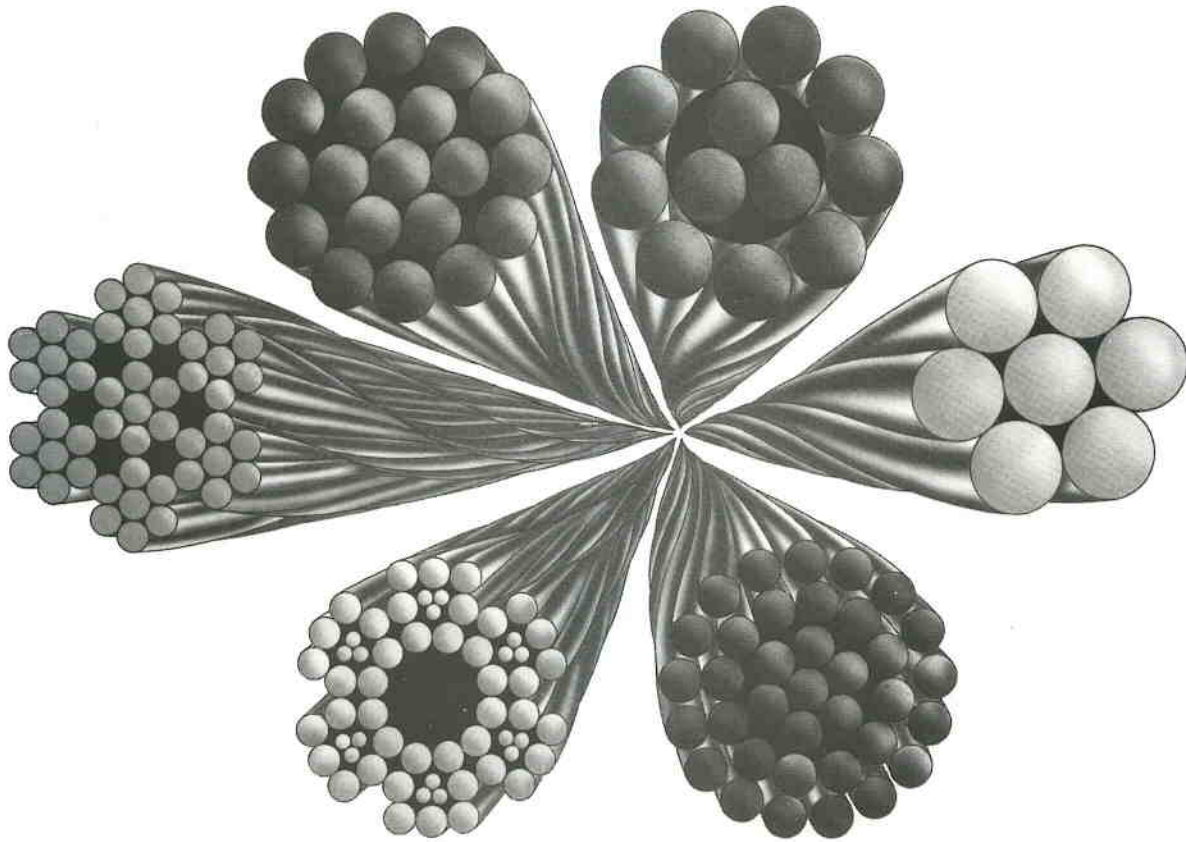

Component Parts of Wire Rope

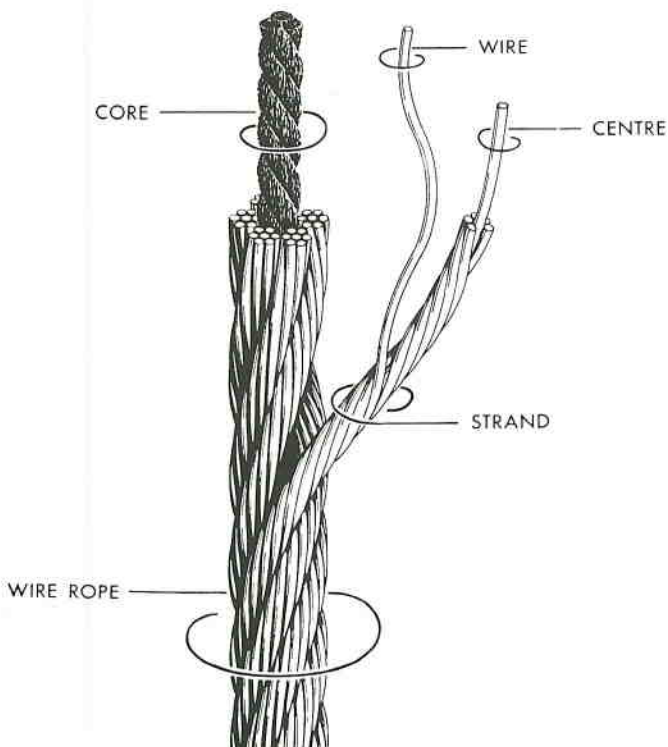

Ropes available in various diameters, constructions and finishes.

Manufactured to various international standards.

See overleaf



1 x 19 (12/6/1)
galvanised and stainless steel,
1770 MPa

Control cables,
general engineering

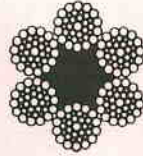

6 x 36 (14/7+7/7/1) fibre core,
galvanised and ungalvanised,
1770 and 1960 MPa

Mining, slings,
general engineering,
winches, hoists,
cranes

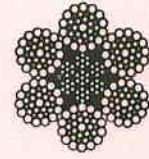

6 x 36 (14/7+7/7/1)
IWRC galvanised and ungalvanised,
1770 and 1960 MPa

Mining, slings,
general engineering,
winches, hoists,
cranes

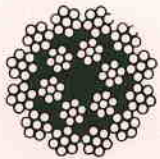

18 x 7 - 12 x 7 (6/1)/6 x 7(6/1) fibre core and
19 x 7 - 12 x 7 (6/1)/6 x 7(6/1)/1 x 7 (6 x 1)
non-spin,
ungalvanised,
1770 and
1960MPa

Cranes, general
engineering, drilling,
non-spin applications

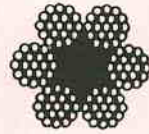

6 x 19 (12/6/1) fibre core,
galvanised, 1770 MPa

Mining, slings,
general engineering,
drilling



6 x 7(6/1)
fibre core,
galvanised,
1770 MPa

General purpose,
where less flexibility
is required

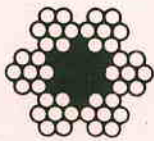

6 x 7 (6/1)
fibre core,
galvanised,
1770 MPa,
PVC covered

General purpose and
bell-wire applications

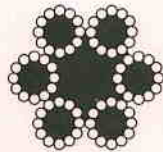

6 x 12 (12/fc)
fibre core,
galvanised,

General engineering,
lashing, blasting barricades

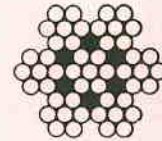

7 x 7 (6/1)
stainless,
grade 304
and 316,
and galvanised

For use with stainless steel and
copper fittings, where rust prevention
is essential



7 x 19 (12/6/1)
stainless
grade 304
and 316

— ENQUIRE ABOUT OUR RANGE OF 8x19, 8x26, 6x36 AND 35x7 COMPACTED STRANDS,
2160MPa HIGH PERFORMANCE ROPES —

WIRE ROPE SLINGS

Specify diameter and give sizes

required as shown by the letters

L - D - E

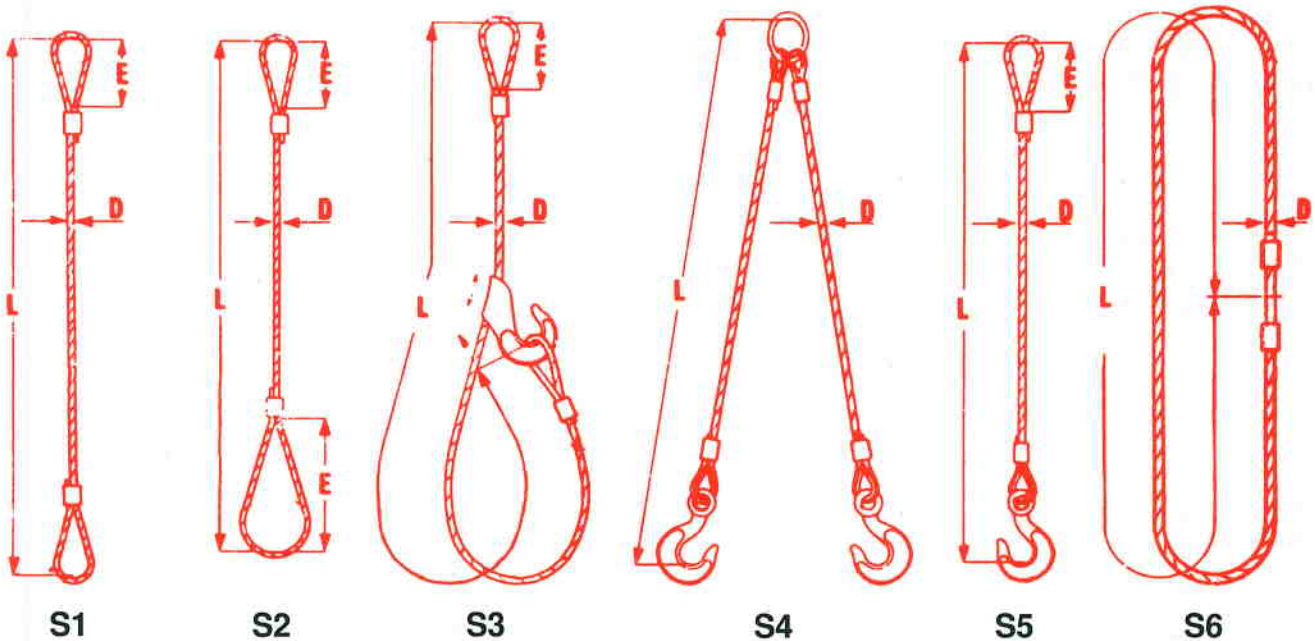

SLING SELECTION

- working load -
- end fittings e.g. hooks -
- eye sizes for soft (unthimbled) eyes -
- thimble dimensions for thimbled eyes -
- rope construction where not standard -

SAFE WORKING LOADS OVERLEAF

**APPROXIMATE SAFE WORKING LOADS IN KG
FOR ALUMINIUM FERRULED STEEL WIRE ROPE SLINGS**

Rope diameter mm	Standard Soft Eye Sizes	Single Leg at 0°	Double Leg at 60°	Double Leg at 90°	Double Leg at 120°	Triple (30°) & Quadruple Leg at 60°	Triple (45°) & Quadruple Leg at 90°	Triple (60°) & Quadruple Leg at 120°
6	100	300	510	420	300	760	630	450
8	100	600	1020	840	600	1520	1260	900
10	150	1000	1700	1400	1000	2530	2100	1500
13	200	1500	2550	2100	1500	3800	3150	2250
16	250	2000	3400	2800	2000	5060	4200	3000
19	350	3000	5100	4200	3000	7600	6300	4500
22	350	4000	6800	5600	4000	10130	8400	6000
26	400	6000	10200	8400	6000	15200	12600	9000
28	450	8000	13600	11200	8000	20260	16800	12000
32	600	10000	17000	14000	10000	25330	21000	15000
38	750	14600	24820	20440	14600	36980	30660	21900
44	900	19500	33150	27300	19500	49400	40950	29250
50	1000	25200	42840	35280	25200	63840	52920	37800
56	1200	32000	54400	44800	32000	81060	67200	48000

STANDARD ROPES USED

Generally 6 x 36 (14/7+7/7/1) fibre core ungalvanised or galvanised

SAFETY FACTOR 6:1

GRADE 80 CHAIN SLINGS AND FITTINGS



Single-leg sling

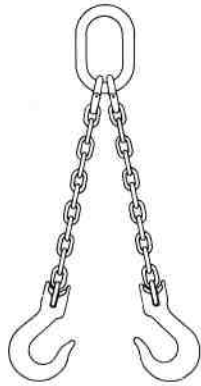

Double-leg sling



Triple and Quadruple
leg slings



Master Link



Master Link Assembly



Chain Connector



Clevis Sling Hook



Clevis Grab Hook

**Eye Sling Hooks, Swivel Hooks, Foundry Hooks, Self -Locking Safety Hooks,
Coupling Links, Shortening Clutches and Reeveable Egg Links
also available.**

P.T.O. FOR WORKING LOAD LIMITS

WORKING LOAD LIMITS FOR GRADE 80 CHAIN SLINGS

Size (d)	Single	Two-leg			Three-leg			Four-leg		
		χ 60°	χ 90°	χ 120°	β 30°	β 45°	β 60°	χ 60°	χ 90°	χ 120°
mm	t	t	t	t	t	t	t	t	t	t
7	1.50	2.55	2.10	1.50	3.80	3.15	2.25	3.80	3.15	2.25
10	3.15	5.36	4.41	3.15	7.98	6.62	4.73	7.98	6.62	4.73
13	5.30	9.01	7.42	5.30	13.43	11.13	7.95	13.43	11.13	7.95
16	8.00	13.60	11.20	8.00	20.27	16.80	12.00	20.27	16.80	12.00
20	12.50	21.25	17.50	12.50	31.67	26.25	18.75	31.67	26.25	18.75
22	15.00	25.50	21.00	15.00	38.00	31.50	22.50	38.00	31.50	22.50
26	20.40	34.68	28.56	20.40	51.68	42.84	30.60	51.68	42.84	30.60
32	31.50	53.55	44.10	31.50	79.80	66.15	47.25	79.80	66.15	47.25

SAFETY FACTOR 4 : 1

POLYESTER DUPLEX FLAT WEBBING SLINGS

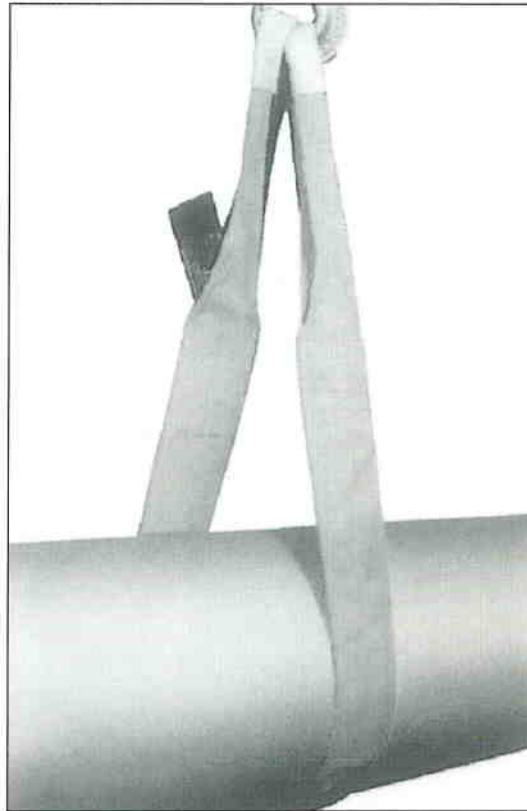

VERTICAL

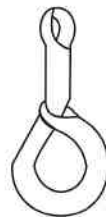

CHOKER

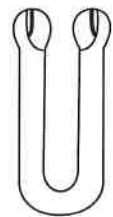

BASKET

SAFE WORKING LOADS IN Kg.						
	50mm WEBBING VIOLET	60mm WEBBING GREEN	90mm WEBBING YELLOW	120mm WEBBING GREY	150mm WEBBING RED	180mm WEBBING BROWN
VERTICAL	1 000 Kg	2 000 Kg	3 000 Kg	4 000 Kg	5 000 Kg	6 000 Kg
CHOKER	800 Kg	1 600 Kg	2 400 Kg	3 200 Kg	4 000 Kg	4 800 Kg
BASKET	2 000 Kg	4 000 Kg	6 000 Kg	8 000 Kg	10 000 Kg	12 000 Kg

— COMPLETE WITH REINFORCED SOFT EYES —

— COLOUR CODED FOR EASY IDENTIFICATION OF SWL —

— ALL SLINGS ARE MANUFACTURED TO COMPLY WITH EN 1492-1:2000
AND SANS 94-1:2003 —

— SLINGS WITH HIGHER SAFE WORKING LOADS AVAILABLE ON REQUEST —

SAFETY FACTOR 7:1

ENDLESS ROUND SLINGS

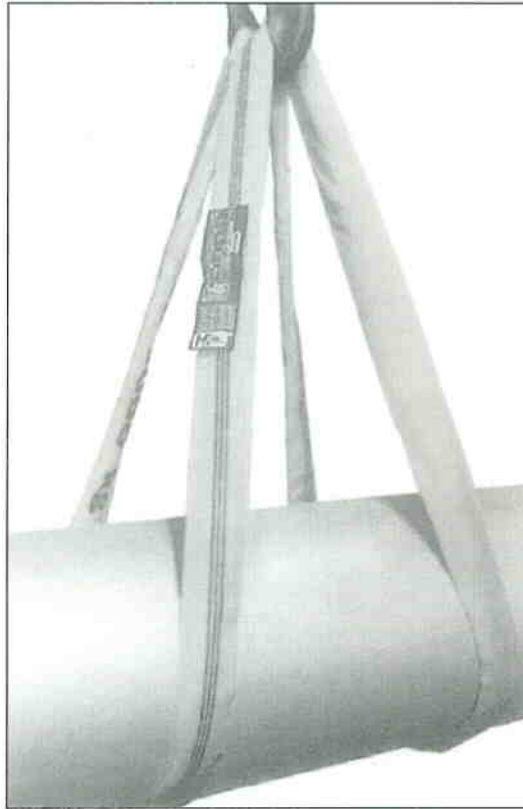

VERTICAL

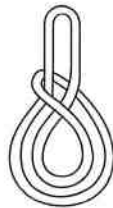

CHOKER

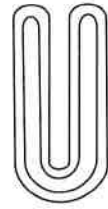

BASKET

SAFE WORKING LOADS IN Kg.						
	VIOLET	GREEN	YELLOW	GREY	RED	BROWN
VERTICAL	1 000 Kg	2 000 Kg	3 000 Kg	4 000 Kg	5 000 Kg	6 000 Kg
CHOKER	800 Kg	1 600 Kg	2 400 Kg	3 200 Kg	4 000 Kg	4 800 Kg
BASKET	2 000 Kg	4 000 Kg	6 000 Kg	8 000 Kg	10 000 Kg	12 000 Kg

— MADE OF HIGH TENSILE YARN IN A CONTINUOUS SPUN LENGTH —

— ENCASED IN MATCHED PROTECTIVE SLEEVE —

— ALL SLINGS ARE MANUFACTURED TO COMPLY WITH EN 1492-2:2000
AND SANS 94-2:2003 —

— SLINGS WITH HIGHER SAFE WORKING LOADS AVAILABLE ON REQUEST —

SAFETY FACTOR 7:1

FITOP ELECTRIC HOISTS AND MOTORIZED CRAWLS

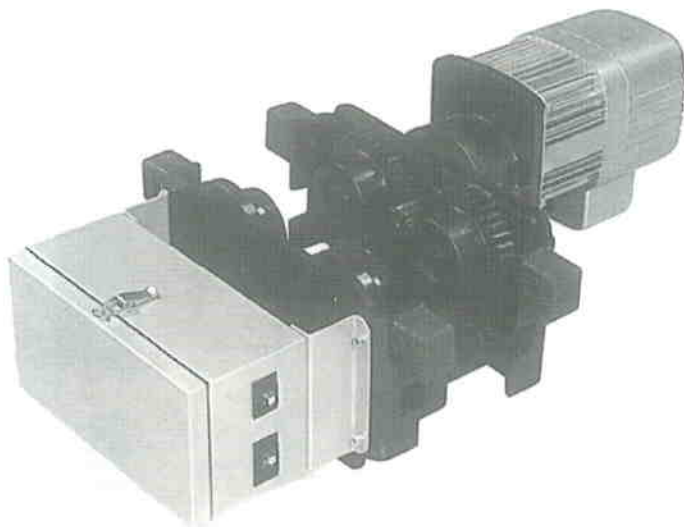

- Low headroom design.
- High duty cycle, 360 starts per hour standard.
- Heavy duty hoist motor with class H insulation.
- Ideal lifting speeds.
- High output motors.
- Negative phase detector.
- True modular design.
- Grade 80 super alloy load chain, 6 to 1 safety factor.
- Chain bag standard.
- The unique D.C. brake design does not break the kinetic bond between the holding brake and the lifted load. The brake design also incorporates a manual release mechanism in case of power failure.
- Overload protection via advanced external slip clutch.
- Sealed electrical enclosure.
- Upper and lower paddle type limit switch has built-in chain guides.
- Lightweight pendant is double insulated and ergonomically designed.
- 48 volt low-voltage control standard.
- Motorized crawl includes D.C. disc brake and control.
- Motorized crawl hoists are supplied with a four-button pendant control.
- Standard voltages: 380V/50Hz, and 525V/50Hz.

SPECIFICATIONS AND DIMENSIONS

Capacity (ton)	Single or dual speed	Output (kW)	Speed (m/min)	Chain falls	Chain dia (mm)	Weight (kg)	A (mm)	B (mm)	C (mm)	D (mm)	E (mm)	F (mm)	G (mm)
1/2	Single	0,94	8	1	5,6	37	410	215	264	158	105	319	38
1/2	Dual	0,94/0,31	8/2,7	1	5,6	39	410	255	264	158	105	319	38
1	Single	1,88	8	1	7,1	52	542	229	256	161	124	430	33
1	Dual	1,88/0,63	8/2,7	1	7,1	57	542	269	256	161	124	430	33
2	Single	3,75	8	1	10	118	697	290	297	200	143	557	47
2	Dual	3,75/1,25	8/2,7	1	10	122	697	331	297	200	143	557	47
2	Single	1,88	4	2	7,1	57	654	229	256	194	91	514	33
3	Single	3,75	4,8	2	10	132	834	290	297	247	96	668	47
3	Dual	3,75/1,25	4,8/1,6	2	10	136	834	331	297	247	96	668	47
5	Single	4,5	3,7	2	11,2	146	867	310	297	247	96	697	47
5	Dual	4,5/1,5	3,7/1,2	2	11,2	150	867	360	297	247	96	697	47

Weight includes 3 metre lift

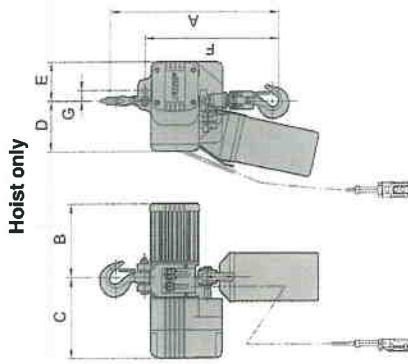

Hoist only

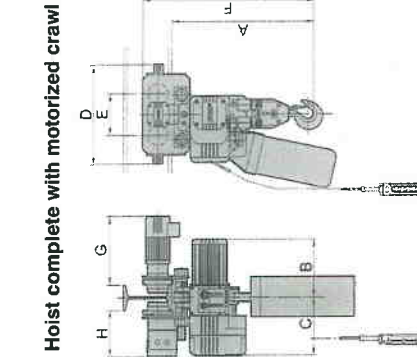

Hoist complete with motorized crawl

Capacity (ton)	Single or dual speed	Output (kW)	Speed (m/min)	Chain falls	Chain dia (mm)	Weight (kg)	A (mm)	B (mm)	C (mm)	D (mm)	E (mm)	F (mm)	G (mm)	H (mm)
1/2	Single	0,94	8	1	5,6	59	470	215	264	390	152	478	334	231
1/2	Dual	0,94/0,31	8/2,7	1	5,6	61	470	255	264	390	152	478	374	231
1	Single	1,88	8	1	7,1	93	617	229	256	390	152	717	334	231
1	Dual	1,88/0,63	8/2,7	1	7,1	98	617	269	256	390	152	717	374	231
2	Single	3,75	8	1	10	166	787	290	297	440	182	897	345	239
2	Dual	3,75/1,25	8/2,7	1	10	170	787	331	297	440	182	897	385	239
2	Single	1,88	4	2	7,1	90	792	229	256	440	182	897	345	239
3	Single	3,75	4,8	2	10	205	944	290	297	510	212	1089	345	239
3	Dual	3,75/1,25	4,8/1,6	2	10	209	944	331	297	510	212	1089	385	239
5	Single	4,5	3,7	2	11,2	266	992	310	297	586	252	1167	394	247
5	Dual	4,5/1,5	3,7/1,2	2	11,2	270	992	360	297	586	252	1167	394	247

Weight includes 3 metre lift

Capacity (ton)	Single or dual speed	Output (kW)	Speed (m/min)	Beam adj (mm)	Wheel dia (mm)	Min radius (mm)	D (mm)	E (mm)	G (mm)	H (mm)	I (mm)
1	Single	0,25	21	75-175	66	800	390	152	334	231	88
1	Dual	0,23/0,08	21/7	75-175	66	800	390	152	374	231	88
2	Single	0,25	21	100-200	88	800	440	182	345	239	106
2	Dual	0,23/0,08	21/7	100-200	88	800	440	182	385	239	106
3	Single	0,75	17	100-250	110	1000	510	212	345	239	129
3	Dual	0,57/0,19	17/5,6	100-250	110	1000	510	212	385	239	129
5	Single	0,75	18	125-300	145	1800	586	252	394	247	148
5	Dual	0,57/0,19	18/6	125-300	145	1800	586	252	394	247	148

Refer 'Vitalift Crawlers' leaflet for specifications on plain and geared crawls

Motorized crawl

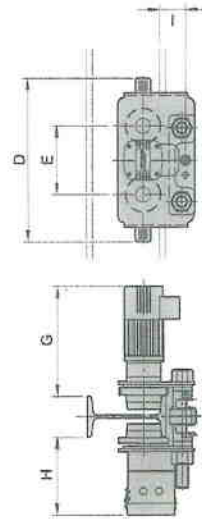



BUILDERS HOIST



FEATURES:

- COMPACT AND LIGHTWEIGHT DESIGN
- EASILY MOUNTED
- LIMIT LEVER SWITCH PREVENTS OVER-WINDING
- DOUBLE BRAKE SYSTEM
- PLUG-IN CONNECTIONS FOR MAXIMUM PORTABILITY
- COMPLETE WITH 360° UNIVERSAL JOINT SADDLE HOOK

SUPER MINI • SUPER LIGHT • HIGH SPEED • HIGH PERFORMANCE

MODEL	DU-250A
CAPACITY	250 Kg
SPEED	15M / Min
OUTPUT	1.3 kW
VOLTAGE	220V Single Phase
ROPE	5mm, 6 x 19, FC Galv.
MAX LIFT	60M
DUTY CYCLE	30 %
HEADROOM	700 mm
NET WEIGHT	20 Kg



MINI ELECTRIC CHAIN HOIST



FEATURES:

- DOUBLE BRAKE SYSTEM
- OVER-ROLL PREVENTION DEVICE
- OVERLOAD LIMIT DEVICE
- LIGHTWEIGHT MODULAR DESIGN WITH FEWER PARTS FOR EASY MAINTENANCE
- WEATHER AND DUST PROTECTION
- ONE-PIECE CASTING OF LOAD FRAME
- FRAME HAS BAKED FINISH FOR SUPERIOR RESISTANCE TO HARMFUL ENVIRONMENTS

SUPER MINI • SUPER LIGHT • HIGH PERFORMANCE

MODEL	DU-901	DU-902
CAPACITY	500 Kg	1000 Kg
SPEED	5M / Min	2.5M / Min
OUTPUT	1.2 kW	1.2 kW
VOLTAGE	220V Single Phase	220V Single Phase
CHAIN	6,3 x 19 mm	6,3 x 19 mm
NO. OF FALLS	1	2
DUTY CYCLE	30 %	30 %
HEADROOM	500 mm	500 mm
NET WEIGHT	23 Kg	30 Kg

MAXILIFT CHAIN BLOCKS

Developed for use in the rigorous ship-building industry, these are **heavy duty** units particularly suited to our demanding South African conditions. They are manufactured in accordance with ISO 9001 certified quality system standards.

SPECIAL FEATURES:

- Forged steel welded hook casings are used instead of cast casings.
- Specially designed hand wheels and side plates provide extremely efficient dust and dirt protection.
- Load sheaves are forged steel, heat treated and expertly machined for extra durability and fatigue resistance.
- Hand wheel covers are designed to prevent hand chains from twisting and jamming.



SPECIFICATIONS

Model	Capacity (ton)	Load chain falls	Pulling effort (kg)	Drawn-up height (mm)	Weight c/w 3m lift (kg)
80010	1,0	1	30	320	14
80015CT	1,5	1	33	330	15
80020CT	2,0	1	35	360	20
80030	3,0	2	34	530	28
80050	5,0	3	39	670	43
80100	10,0	3	49	850	91
80200	20,0	6	49 x 2	1250	337
80300	30,0	10	52 x 2	1450	492
80400	40,0	14	54 x 2	1650	750

SEE OVERLEAF FOR PARTS LIST

ILULA CHAIN BLOCKS

These units are of lightweight but robust construction, manufactured in accordance with ISO 9002 certified quality system standards. They comply with EC Council Directive 89/37/EC Machinery, ASME B30, AS1418.2.



SPECIAL FEATURES:

- Extra-thick asbestos-free friction plates.
- Double pawl braking system.
- Lipped hooks, providing extra safety.
- Double cover protection on brake side.
- Galvanized hand chain.

SPECIFICATIONS

Model	Capacity (ton)	Load chain falls	Pulling effort (kg)	Drawn-up height (mm)	Weight c/w 3M pull (kg)
E005	0,5	1	23	270	8
E010	1,0	1	31	317	12
E015	1,5	1	32	399	18
E020	2,0	1	36	414	18
* E030	3,0	2	34	465	25
E050	5,0	2	42	636	45
E100	10,0	4	42	798	79
E200	20,0	8	42 x 2	890	193

SEE OVERLEAF FOR PARTS LIST

* 3,0 ton available with single fall	3,0	1	38	570	28
--------------------------------------	-----	---	----	-----	----

MAXIPULL LEVER BLOCKS

These blocks have been tried and tested in the tough ship-building industry, and are **heavy duty** units able to cope with hard South African conditions. They are manufactured to ISO 9002 certified quality system standards.

FEATURES INCLUDE:

- Forged steel welded hook casings in place of cast casings.
- Fast free-wheeling system, ensuring minimum operating time.
- Forged steel, heat treated load sheaves for longer service and high fatigue resistance.
- Fail-safe mechanisms to prevent loads from slipping or falling.



SPECIFICATIONS

Model	Capacity (ton)	Load chain falls	Levering effort (kg)	Drawn-up height (mm)	Weight c/w 3m pull (kg)
81015	1,5	1	21	370	13
81030	3	1	34	450	22
81060	6	2	36	580	37

SEE OVERLEAF FOR PARTS LIST

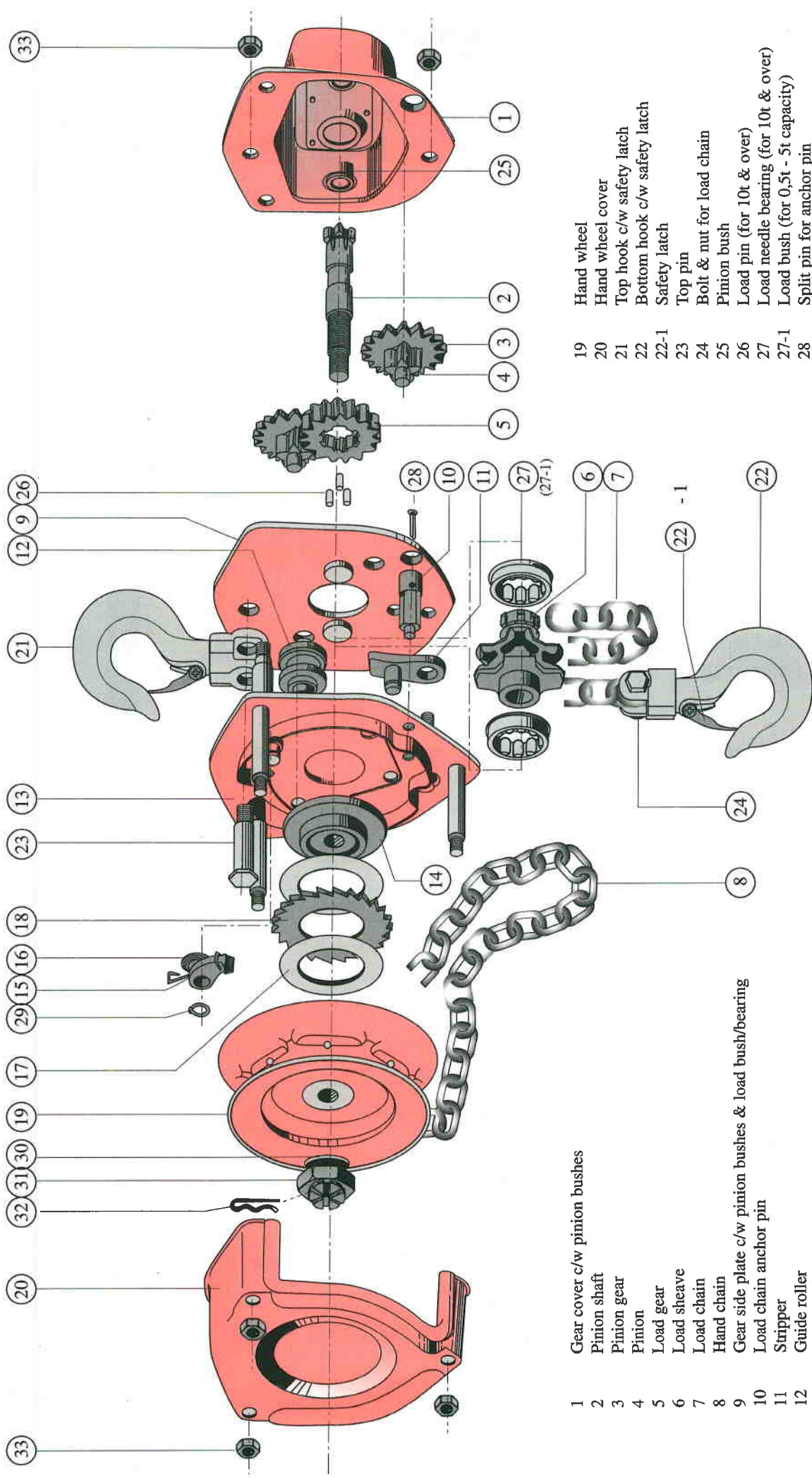

- 1 Gear cover c/w pinion bushes
- 2 Pinion shaft
- 3 Pinion gear
- 4 Pinion
- 5 Load gear
- 6 Load sheave
- 7 Load chain
- 8 Hand chain
- 9 Gear side plate c/w pinion bushes & load bush/bearing
- 10 Load chain anchor pin
- 11 Stripper
- 12 Guide roller
- 13 Wheel side plate c/w stay bolts & load bush/bearing
- 14 Disc hub
- 15 Pawl
- 16 Pawl spring
- 17 Friction plate
- 18 Ratchet

- 19 Hand wheel
- 20 Hand wheel cover
- 21 Top hook c/w safety latch
- 22 Bottom hook c/w safety latch
- 22-1 Safety latch
- 23 Top pin
- 24 Bolt & nut for load chain
- 25 Pinion bush
- 26 Load pin (for 10t & over)
- 27 Load needle bearing (for 10t & over)
- 27-1 Load bush (for 0,5t - 5t capacity)
- 28 Split pin for anchor pin
- 29 Snap ring for pawl
- 30 Hand wheel washer
- 31 Pinion shaft nut
- 32 Cotter pin
- 33 Nut
- 34 Nameplate & rivets

ILULA LEVER BLOCKS

These units are of lightweight but robust construction, manufactured in accordance with ISO 9002 certified quality system standards. They comply with EC Council Directive 89/37/EC Machinery, ASME B30, AS1418.2.

SPECIAL FEATURES:

- Extra-thick asbestos-free friction plates.
- Double pawl braking system.
- Lipped hooks, providing extra safety.
- Time-saving rapid free-wheeling system.
- Unique holding system, ensuring that chain cannot free-wheel under load in the event of neutral being accidentally engaged.



SPECIFICATIONS

Model	Capacity (ton)	Load chain falls	Levering effort (kg)	Drawn-up height (mm)	Weight c/w 3M pull (kg)
LHA075	0,75	1	14	325	8
LHA150	1,5	1	22	380	13
LHA300	3,0	1	32	480	22
LHA600	6,0	2	34	620	36
LHA900	9,0	3	36	700	53

SEE OVERLEAF FOR PARTS LIST

**ALSO AVAILABLE: SUPER-LIGHT 250KG ILULA LEVER BLOCK
WITH BELT-ATTACHABLE POUCH**

- 1 Gear cover
- 2 End anchor pin c/w split pin
- 3 End anchor
- 4 Chain pin and lock nut
- 5 Load chain
- 6 Stripper
- 7 Bottom hook c/w safety latch
- 8 Safety latch
- 9 Bearing
- 10 Wheel side plate c/w stay bolts and load bush
- 11 Stay bolt
- 12 Hub
- 13 Top hook pin
- 14 Hand chain
- 15 Disc gear assembly
- 16 Pinion shaft
- 17 Splined gear

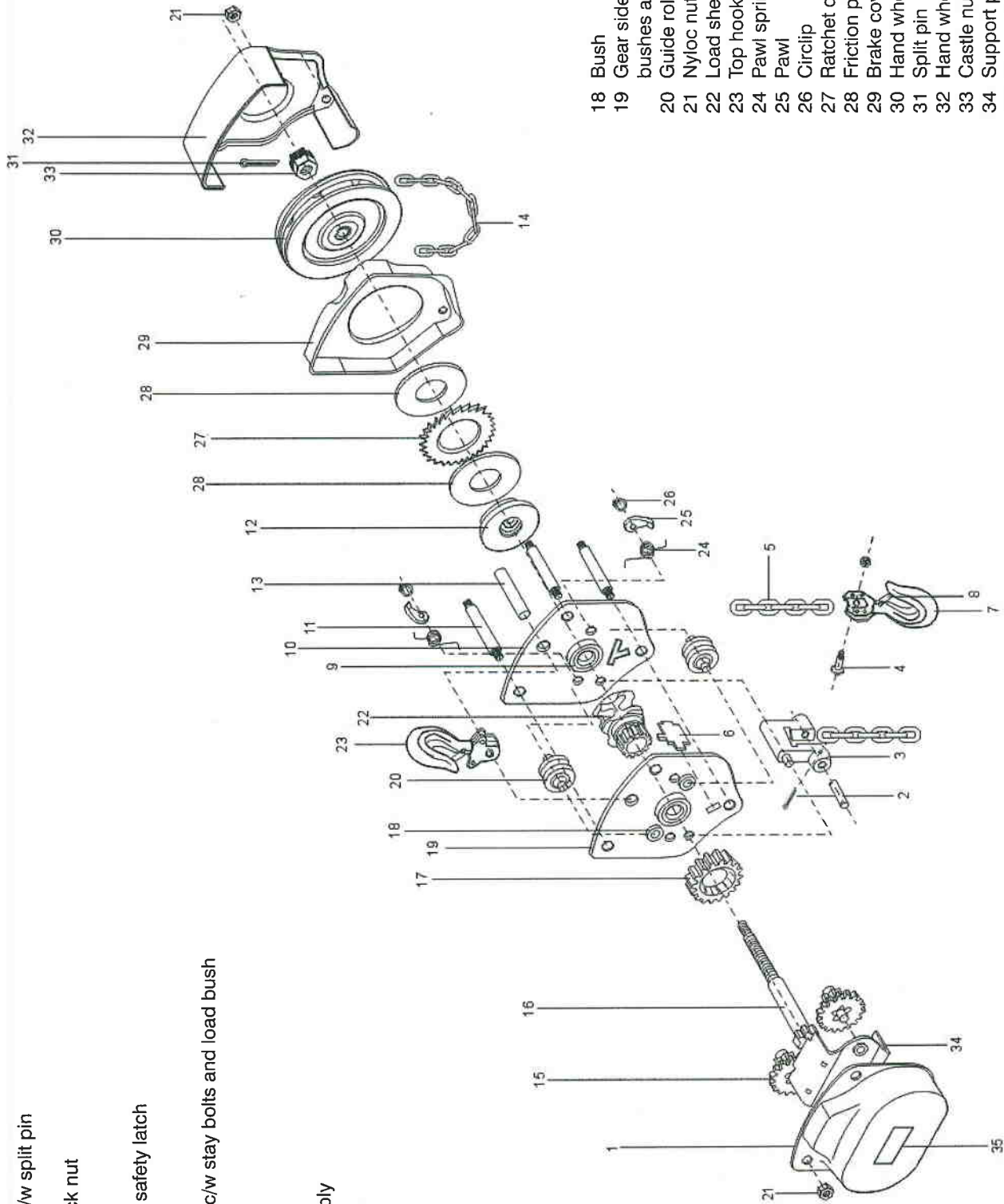

- 18 Bush
- 19 Gear side plate c/w pinion bushes and load bush
- 20 Guide roller
- 21 Nyloc nut
- 22 Load sheave
- 23 Top hook c/w safety latch
- 24 Pawl spring
- 25 Pawl
- 26 Circlip
- 27 Ratchet disc
- 28 Friction plate
- 29 Brake cover
- 30 Hand wheel
- 31 Split pin
- 32 Hand wheel cover
- 33 Castle nut
- 34 Support plate
- 35 Name plate c/w rivets

MAXIPULL LEVER BLOCKS

These blocks have been tried and tested in the tough ship-building industry, and are **heavy duty** units able to cope with hard South African conditions. They are manufactured to ISO 9002 certified quality system standards.

FEATURES INCLUDE:

- Forged steel welded hook casings in place of cast casings.
- Fast free-wheeling system, ensuring minimum operating time.
- Forged steel, heat treated load sheaves for longer service and high fatigue resistance.
- Fail-safe mechanisms to prevent loads from slipping or falling.



SPECIFICATIONS

Model	Capacity (ton)	Load chain falls	Levering effort (kg)	Drawn-up height (mm)	Weight c/w 3m pull (kg)
81015	1,5	1	21	370	13
81030	3	1	34	450	22
81060	6	2	36	580	37

SEE OVERLEAF FOR PARTS LIST

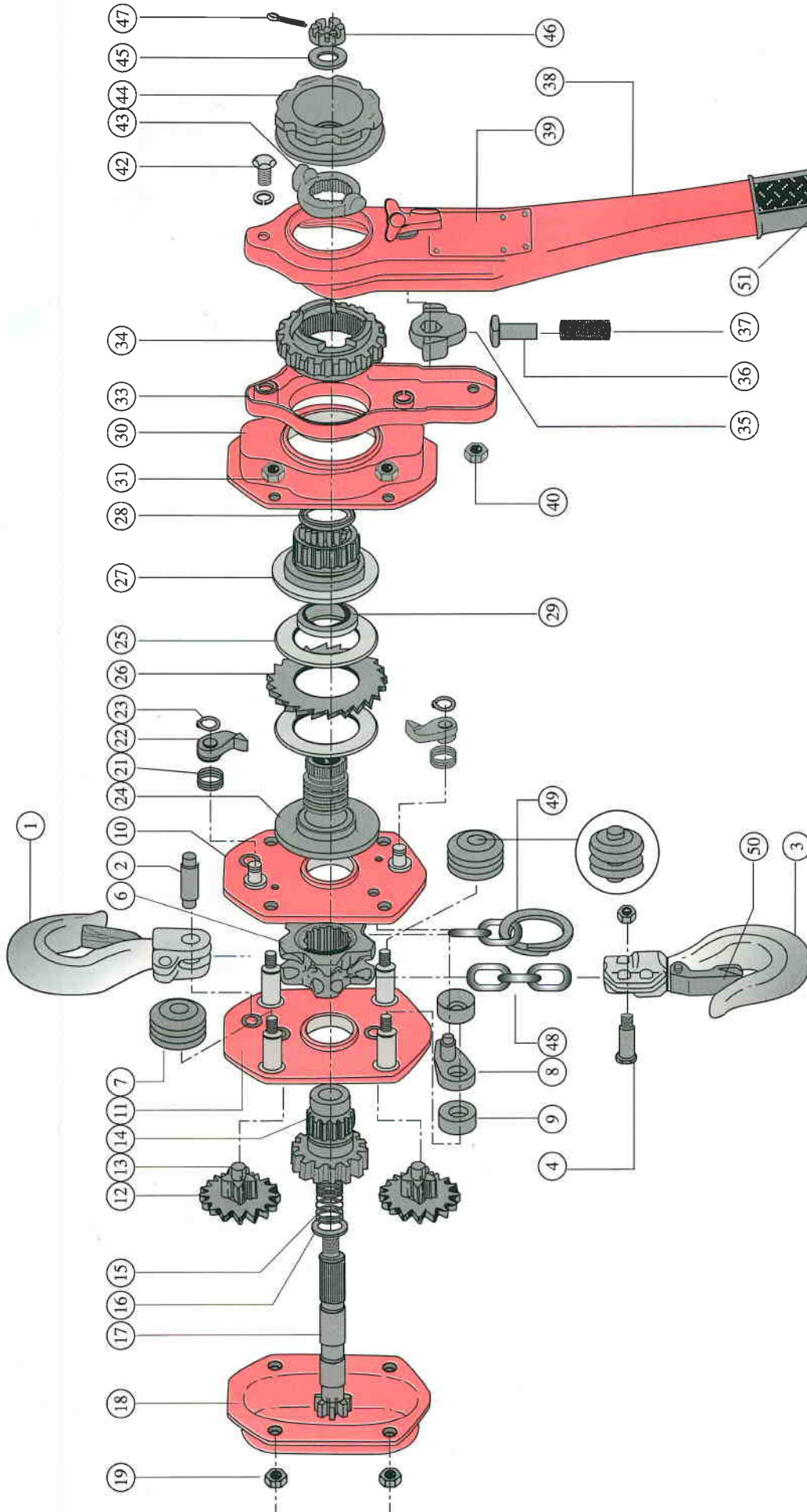

- | | | | | | | | |
|----|---|----|------------------------|----|------------------------|----|---------------------|
| 1 | Top hook c/w safety latch | 21 | Pawl spring | 31 | Nut | 43 | Cam guide |
| 2 | Top pin | 22 | Pawl | 33 | Change-over wheel | 44 | Free knob |
| 3 | Bottom hook c/w safety latch | 23 | Snap ring for pawl | 34 | Change-over wheel | 45 | Pinion shaft washer |
| 4 | Bolt & nut for load chain | 24 | Disc hub | 35 | Change-over pawl | 46 | Pinion shaft nut |
| 6 | Load sheave | 25 | Friction plate | 36 | Spring shaft | 47 | Split pin |
| 7 | Guide roller | 26 | Ratchet | 37 | Change-over spring | 48 | Load chain |
| 8 | Stripper | 27 | Female thread assembly | 38 | Lever assembly | 49 | Chain stopper link |
| 9 | Stripper collar | 28 | Seal A | 39 | Nameplate & rivets | 50 | Safety latch |
| 10 | Brake side plate c/w pawl studs & load bush | 29 | Seal B | 40 | Nut | 51 | Rubber handle grip |
| 11 | Gear side plate c/w stay bolts, pinion bushes & load bush | 30 | Brake cover | 42 | Hex head bolt & washer | | |
| 12 | Pinion gear | | | | | | |
| 13 | Pinion | | | | | | |
| 14 | Load gear | | | | | | |
| 15 | Coil spring | | | | | | |
| 16 | Spring seat | | | | | | |
| 17 | Pinion shaft | | | | | | |
| 18 | Gear cover c/w pinion bushes | | | | | | |
| 19 | Nut | | | | | | |

VITALIFT CRAWLS

PLAIN

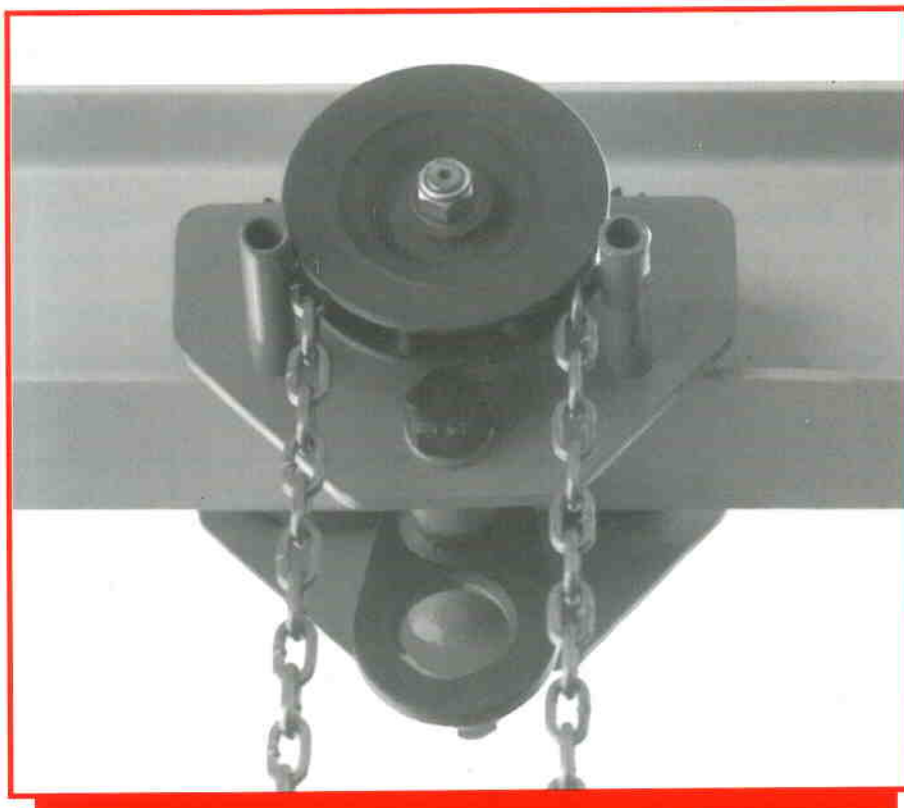

GEARED

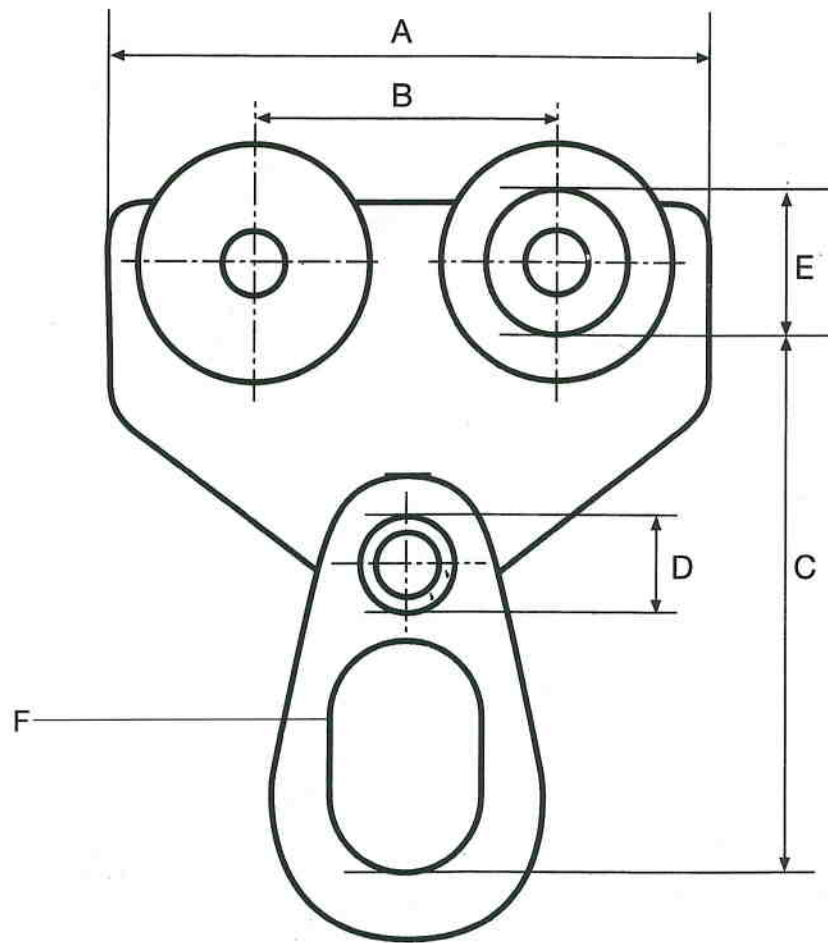

SPECIFICATIONS		CAPACITY							
		½t	1t	2t	3t	5t	10t	20t	
A	Overall length	210mm	210mm	260mm	295mm	345mm	525mm	525mm	
B	Distance between axles (centre to centre)	100mm	100mm	125mm	145mm	170mm	255mm	255mm	
C	Distance between beam base and hook bearing point	145mm	145mm	135mm	170mm	195mm	210mm	250mm	
D	Shaft diameter	20mm	22mm	25mm	30mm	39mm	30mm	54mm	
E	Load wheel diameter (at load -bearing surface)	54mm	54mm	80mm	105mm	115mm	200mm	200mm	
F	Internal width and height of suspension eye	47mm	47mm	50mm	49x69mm	50x78mm	79x120mm	88x120mm	
1	Side plate thickness	8mm	10mm	10mm	12mm	16mm	20mm	30mm	
2	Weight	Plain	8kg	9kg	15kg	25kg	40kg	139kg	N/A
		Geared	N/A	10kg	17kg	27,5kg	45kg	146kg	237kg
3*	To fit beam width	Minimum	76mm	76mm	92mm	92mm	125mm	138mm	145mm
		Maximum	138mm	138mm	152mm	152mm	191mm	230mm	305mm
4	Minimum radius	1,3M	1,3M	1,5M	2M	2,5M	3,5M	3,5M	

* Extended shaft available on request

ROLACRAWLS

PLAIN

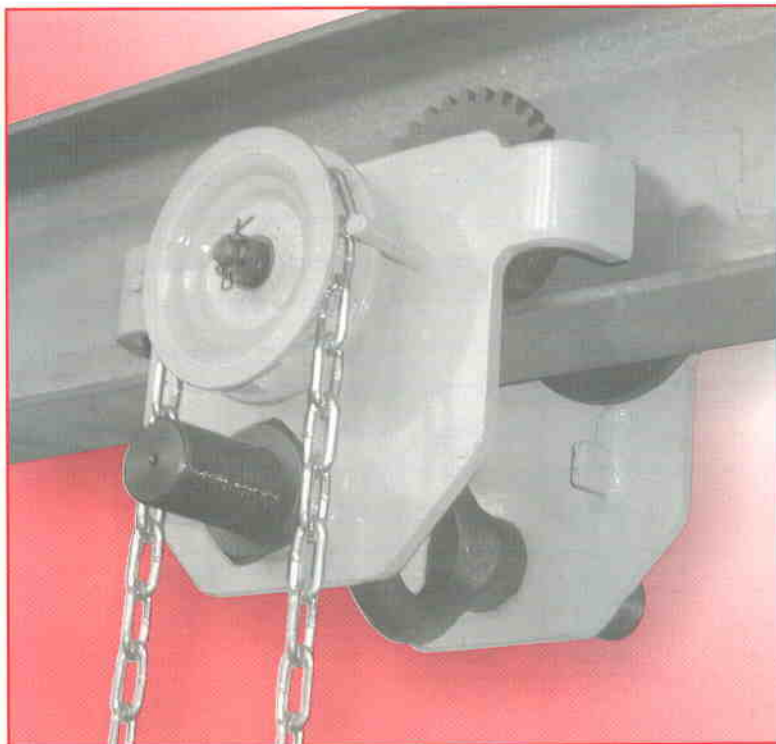

GEARED

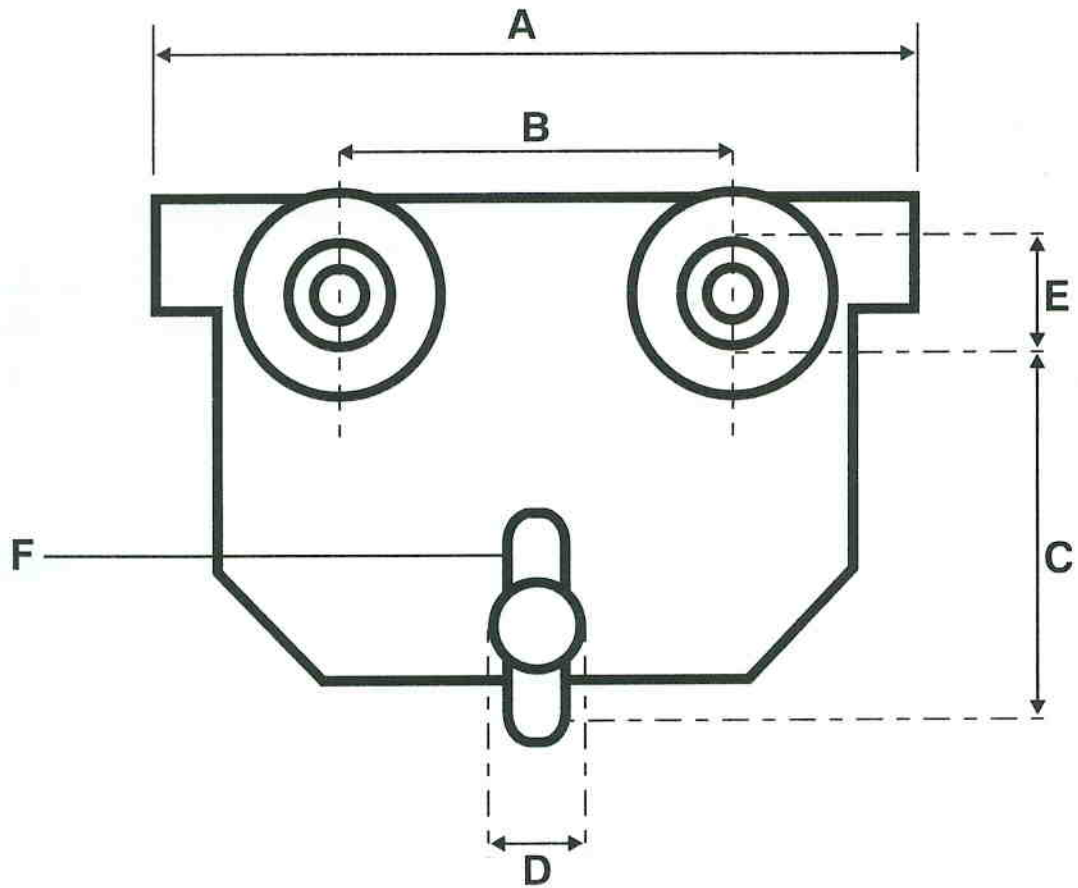

SPECIFICATIONS		CAPACITY					
		½t	1t	2t	3t	5t	
A	Overall length	198mm	245mm	277mm	330mm	380mm	
B	Distance between axles (centre to centre)	100mm	120mm	130mm	160mm	170mm	
C	Distance between beam base and hook bearing point	80mm	105mm	125mm	150mm	160mm	
D	Shaft diameter	24mm	30mm	36mm	41mm	47mm	
E	Load wheel diameter (at load-bearing surface)	55mm	67mm	80mm	100mm	110mm	
F	Internal width and height of suspension eye	24x30mm	30x35mm	40x47mm	44x57mm	50x64mm	
1	Side plate thickness	6mm	8mm	10mm	12mm	16mm	
2	Weight	Plain	5kg	9kg	14,5kg	23,5kg	36,5kg
		Geared	N/A	10kg	15,5kg	25kg	38,5kg
3	To fit beam width	Minimum	50mm	58mm	66mm	74mm	90mm
		Maximum	220mm	220mm	220mm	220mm	220mm
4	Minimum radius	1,3M	1,3M	1,5M	2M	2,5M	

FALL ARRESTORS



HB-6N



HB-10



HB-15



HB-20

Model	Dia. of rope/ webbing (mm)	Length of rope (M)	Max stopping distance (M)	Weight (kg)
HB-6N	25*	6	1,2	1,6
HB-10	4,0	10	1,5	4,6
HB-15	4,0	15	1,5	6,6
HB-20	4,0	20	1,5	8,6

* Nylon webbing

- CONTINUOUS PROTECTION AGAINST FALLS —
- AUTOMATICALLY EXTENDS AND RETRACTS TO ALLOW FREEDOM OF MOVEMENT —
- INCLUDES ANCHORAGE AND EXTENSION ROPES —

— MAXIMUM SAFE CAPACITY OF 150Kg —

FALL ARRESTORS

OPERATING GUIDELINES

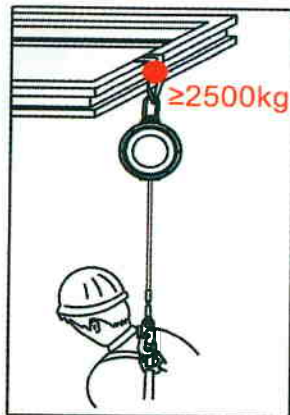

- USE A RIGID ANCHORING POINT CAPABLE OF CARRYING AT LEAST 2 500kg —
- DO NOT WORK ABOVE THE ANCHOR POINT —

- USE AT UP TO 40° —
- DO NOT WORK HORIZONTALLY TO THE FALL ARRESTOR —

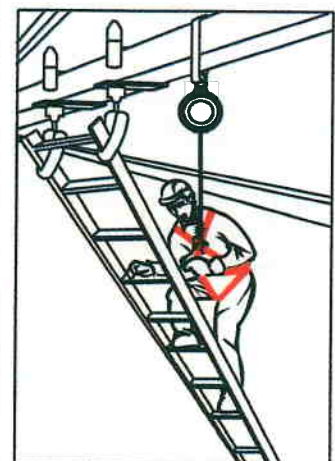
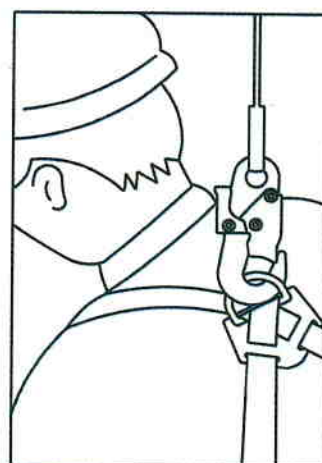
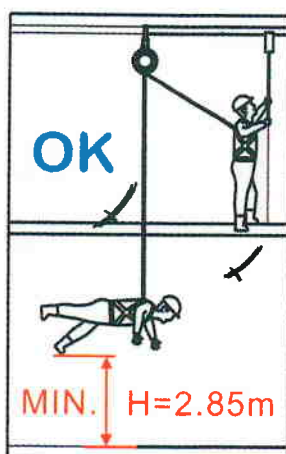

- THE MINIMUM WORKING HEIGHT (H) IS CALCULATED BY ADDING 2,85M TO THE LENGTH OF THE FALL OF THE ROPE —

- THE FALL ARRESTOR MUST BE USED IN CONJUNCTION WITH A FULL BODY HARNESS WHICH CONFORMS TO EN 361, AND ALL CONNECTORS MUST CONFORM TO EN 362 —

LIFTING APPLIANCES

DRUM LIFTERS



HORIZONTAL



VERTICAL



DRUM HOOKS

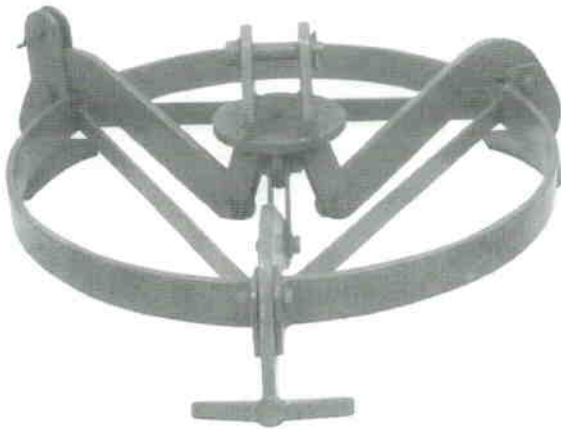

VERTICAL RING

FORKLIFT HOOKS



BEAM CLAMPS



A - FRAMES



THESE STRUCTURES ARE ASSEMBLED USING NUTS AND BOLTS - THIS ALLOWS FOR DISMANTLING TO FACILITATE EASY TRANSPORT AND ACCESS TO DIFFICULT SITES.

AVAILABLE IN THREE STANDARD CAPACITIES:

- 1000KG (76mm BEAM WIDTH)
- 3000KG (89mm BEAM WIDTH)
- 5000KG (146mm BEAM WIDTH)

3 METRES HIGH X 3 METRES WIDE.

OTHER CAPACITIES AND SIZES MADE TO YOUR SPECIFICATIONS.

CONTAINER LIFTING SYSTEMS

FOR LIFTING PARTIALLY FILLED OR
EMPTY SIX METRE CONTAINERS

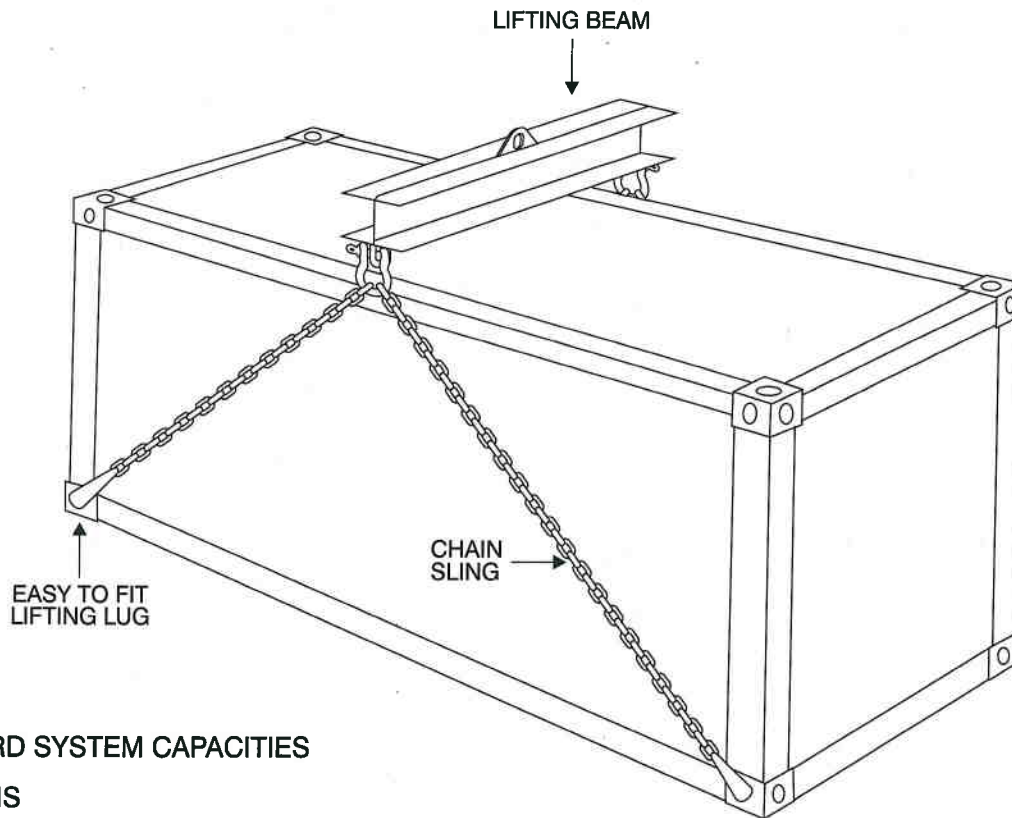

STANDARD SYSTEM CAPACITIES

- 3 TONS
- 6 TONS
- 10 TONS

LUGS ARE AVAILABLE AS SEPARATE ITEMS:

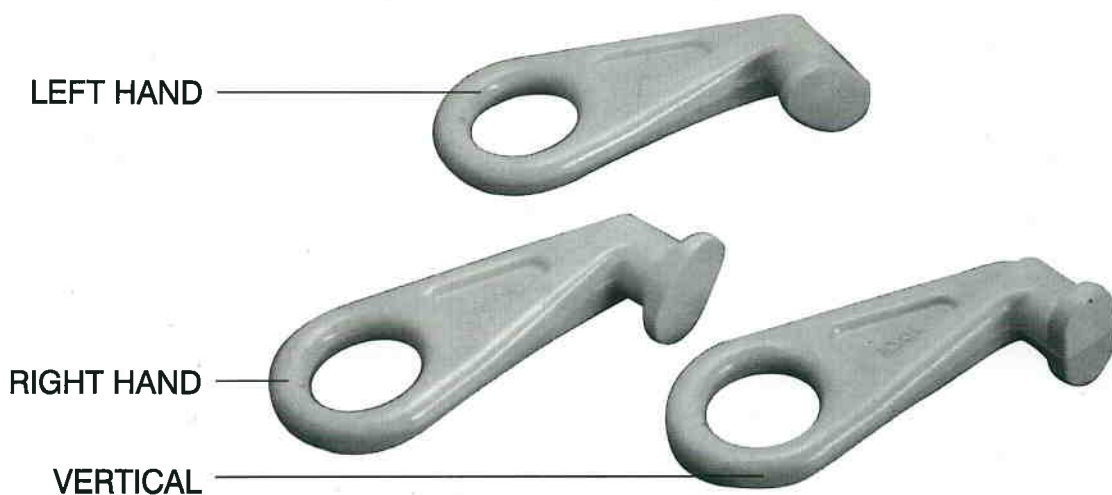

WORKING LOAD LIMIT PER LUG - 12500Kg

SAFETY FACTOR 4 : 1

MANHOLE-RING LIFTING SYSTEMS

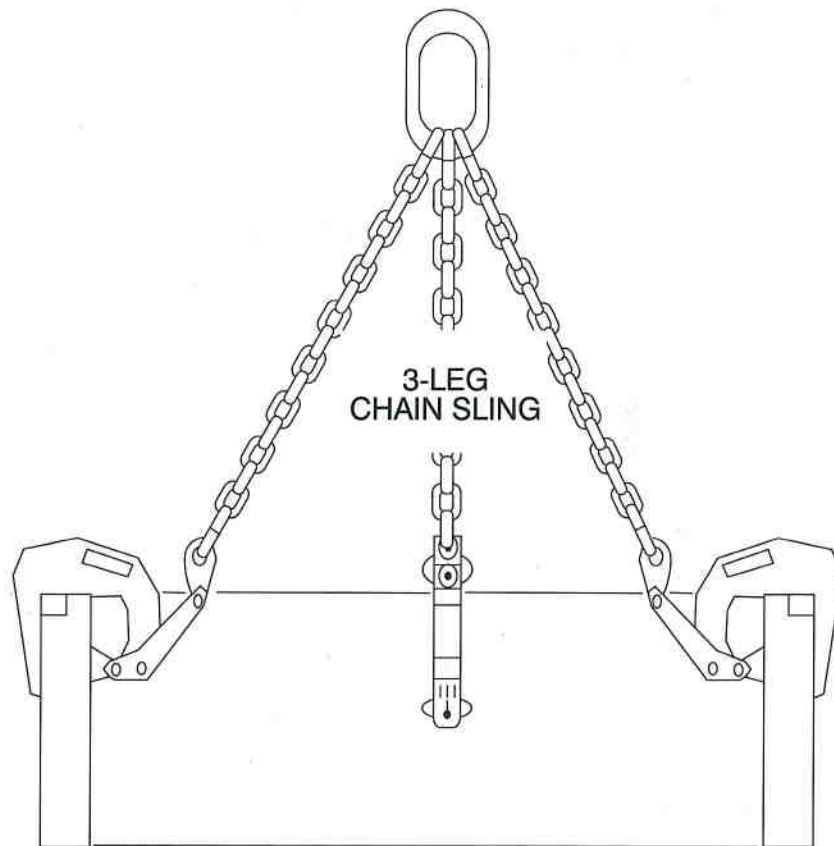

A STANDARD SYSTEM CONSISTS OF A THREE-LEGGED
CHAIN SLING ATTACHED TO THREE LIFTING CLAMPS.



- MINIMUM DIAMETER OF RING - 900mm
- WALL THICKNESS RANGE - 40mm TO 125mm
- MAXIMUM WEIGHT - 2400Kg
- CLAMPS AVAILABLE INDIVIDUALLY

VITALIFT PLATE GRABS



VERTICAL

Capacity (kg)	Jaw opening (mm)	Eye diameter (mm)	Net weight (kg)
1 000	0 - 18	84	6
2 000	0 - 28	78	16
3 000	0 - 30	75	16
5 000	5 - 50	86 x 129	39

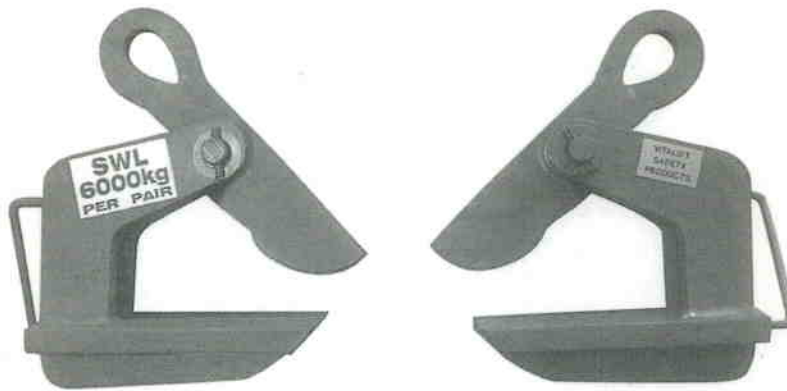

HORIZONTAL

Capacity per pair (kg)	Jaw opening (mm)	Eye size (mm)	Net weight per pair (kg)
1 000	0 - 60	29 x 46	20
3 000	0 - 100	45 x 68	43
6 000	0 - 100	45 x 68	52
10 000	50 - 150	60 x 68	93

UNIVERSAL

Capacity (kg)	Jaw opening (mm)	Eye diameter (mm)	Net weight (kg)
1 000	0 - 18	69	7,4
2 000	0 - 28	72	18
3 000	0 - 30	74	18
5 000	0 - 50	79	44



MAXIGRAB PLATE GRABS



VERTICAL

Capacity (kg)	Jaw opening (mm)	Eye diameter (mm)	Net weight (kg)
1 000	0 - 22	48	4
2 000	0 - 30	57	6
3 000	0 - 35	59	9
5 000	5 - 45	64	17
8 000	5 - 55	64	26



HORIZONTAL

Capacity per pair (kg)	Jaw opening (mm)	Eye diameter (mm)	Net weight per pair (kg)
1 500	0 - 25	25	6
3 000	0 - 30	30	8
4 000	0 - 45	40	12
5 000	0 - 50	29	15
8 000	0 - 85	50	45

UNIVERSAL

Capacity (kg)	Jaw opening (mm)	Eye diameter (mm)	Net weight (kg)
1 000	0 - 20	48	4
2 000	0 - 25	67	7
3 000	0 - 30	74	15
5 000	0 - 50	80	21
8 000	0 - 45	84	37



MAXIMAG LIFTING MAGNETS

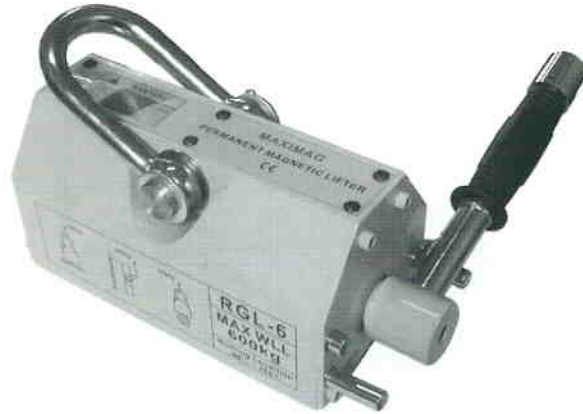

IT IS IMPERATIVE TO DETERMINE THE SUITABILITY OF A MAGNET FOR THE TASK TO BE PERFORMED, MATERIAL THICKNESS AND TYPE INFLUENCE THE WLL. PLEASE CONSULT YOUR DISTRIBUTOR BEFORE PURCHASE.

Model	RGL-1	RGL-3	RGL-6	RGL-10	RGL-20	RGL-30
Rated WLL holding force (KgF) (Diag. 1)	100	300	600	1 000	2 000	3 000
Cylindrical lifting capacity (KgF) (Diag. 2)	30	100	200	300	600	N/A
Maximum break away force (KgF)	350	1 050	2 100	3 500	7 000	10 500
Net weight (Kg)	3	10	24	50	125	220
Max handle turning force (KgF)	<4	<8	<8	<16	<16	<20
Length (mm)	92	162	232	258	378	458
Width (mm)	62	92	122	176	234	286
Height (mm)	67	91	117	163	212	261

Diag. 1

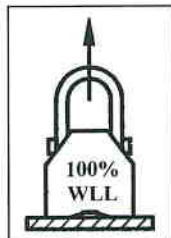

Diag. 2

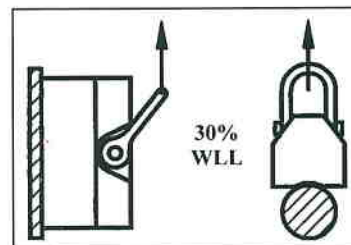

— 3,5 : 1 SAFETY FACTOR —

— SIMPLE LOCKING SWITCH ENABLES ONE-HANDED OPERATION —

— V-SLOT IN LIFTING FACE ALLOWS FOR LIFTING OF FLAT AND ROUNDED SURFACES —

TIGER SF-2200

INDUSTRIAL HAND WINCH

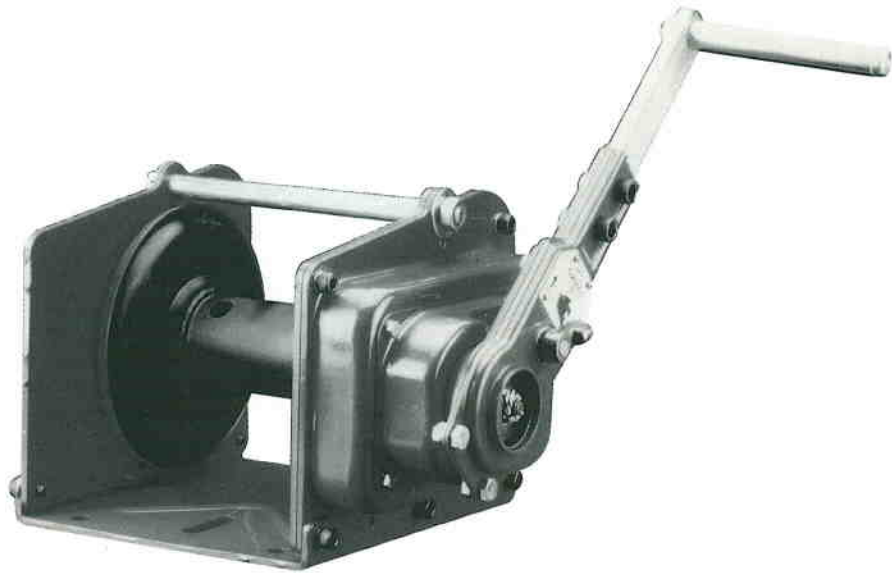

SPECIFICATIONS AND DIMENSIONS	SF-2200
Capacity	1 000 KgF
Levering effort	10 Kg
Gear ratio	22.2 : 1
Rope capacity	35M
Rope diameter	8mm*
Drum diameter	60mm
Net weight	16 Kg

*6x36 IWRC

- MAY BE USED IN LIFTING APPLICATIONS —
- POSITIVE BRAKING SYSTEM ENSURES SUSPENSION OF THE LOAD —
- GEARBOX IS FULLY LUBRICATED AND SEALED —
- LOW LEVERING EFFORT REQUIRED —
- STANDARD WITH UNIVERSAL MOUNTING BASE —

HAND WINCHES



SINGLE
SPEED



DUAL
SPEED



DISC
BRAKE
SYSTEM

PULLING CAPACITY/MODEL (kg of force)	SPEED	GEAR RATIO	ROPE CAPACITY	DRUM DIAMETER (mm)
386	Single	3:1	* 5mm - 12M ** 6mm - 9M	35
545	Single	4:1	* 5mm - 23M ** 6mm - 17M	48
545B	Single	4,1:1	* 5mm - 23M ** 6mm - 17M	48
727	Single	4:1	** 6mm - 17M	48
727B	Single	4,1:1	** 6mm - 17M	48
909	Dual	4:1/ 10:1	***8mm - 12M	48
909B	Single	12:1	***8mm - 11M	60
1136	Dual	5:1/ 12:1	***8mm - 19M	48
1136B	Single	12,1:1	***8mm - 18M	60

- DETACHABLE HANDLES -
- BLACK POWDER-COATED FINISH -
- HAND-BRAKE FITTED TO MODEL 1136 -
- DISC BRAKE SYSTEM FITTED TO MODELS 545B, 727B, 909B AND 1136B -
- DESIGNED FOR DEADLOAD PULLS - MAXIMUM GRADIENT 1 IN 5 -
- MODELS 545B, 727B, 909B AND 1136B ARE SUITABLE FOR LIFTING -

*5mm 6x19 FC ** 6mm 6x36 IWRC ***8mm 6x36 IWRC

MAXIWINCH WIRE ROPE WINCHES



SPECIFICATIONS AND DIMENSIONS	800 kg	1600 kg	3200 kg	5400 kg
Capacity (kg of force)	800	1600	3200	5400
Rope diameter (mm)	8	11	16	20
Net weight (kg)	6	11	22	59
Overall length (mm)	426	545	660	930
Overall height (mm)	235	280	325	480
Overall width (mm)	64	97	116	152

– ALUMINIUM CASINGS –
– OVERLOAD PREVENTION BY SHEAR PINS –

WELDABLE TRANSPORT RINGS



Size	Inside clearance* mm	Inside width mm	Material diameter mm	Safe working load kg	Approx weight kg
8	37	42	14	2000	0,46
10	46	48	18	3150	0,63
13	69	66	24	5300	1,90
16	71	72	28	8000	2,67
22	98	120	39	15000	8,09
32	174	180	56	31500	27,30

*=when perpendicular to the welding level

- CAPABLE OF FULL WORKING LOAD AT ALL ANGLES —
- A PERMANENT LIFTING POINT THAT CAN PIVOT THROUGH 180° —
- GRADE 80 ALLOY STEEL WITH 4:1 SAFETY FACTOR —
- SIZES 8 TO 16 AVAILABLE WITH FIXING SPRING —

EXCAVATOR WELD-ON HOOKS



Safe working load kg	Throat clearance mm	Width mm	Length of base mm	Height mm	Approx weight kg
1000	18	25	95	70	0,6
2000	25	30	115	85	1,0
3000	28	35	133	107	1,4
5000	30	44	167	135	3,1
8000	32	50	176	137	3,5
10000	44	56	222	170	6,2

— ALSO KNOWN AS UTILITY HOOKS —

— 5:1 SAFETY FACTOR —

LIFTING RINGS

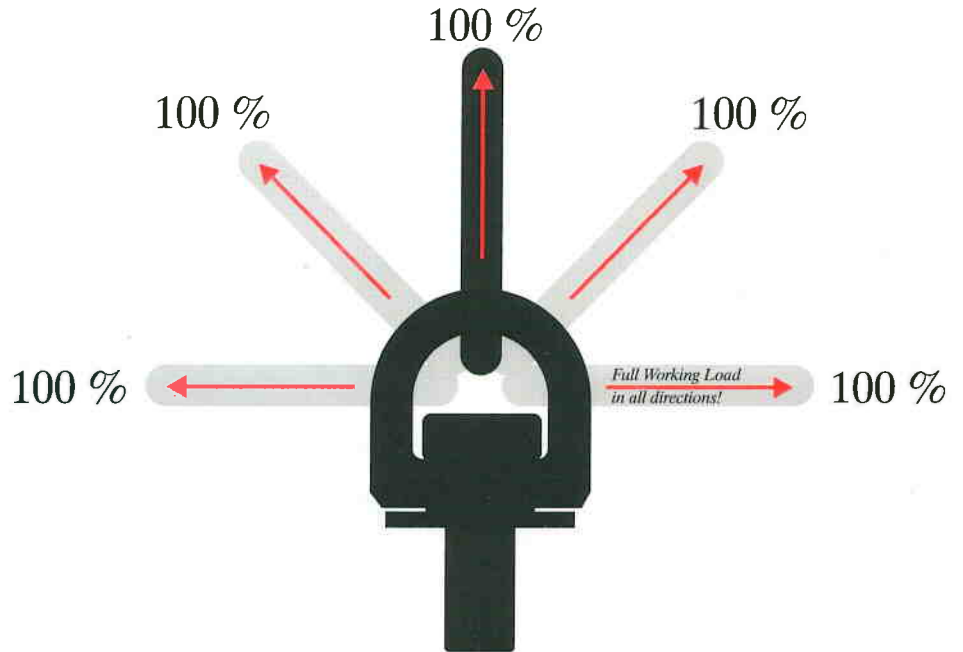

Size (thread dia.) mm	Thread length mm	Inside length (eye) mm	Inside width (eye) mm	Material dia. (eye) mm	Safe working load kg	Approx weight kg
10	19	50	28	10	450	0,41
12	24	50	28	10	600	0,43
16	28	50	28	10	1400	0,47
20	32	60	34	12	2500	0,79
24	40	70	40	16	3500	1,50
30	50	85	50	18	6700	2,70
36	66	115	50	22	8000	4,80

— 4:1 SAFETY FACTOR —

— CAPABLE OF FULL WORKING LOAD IN ALL DIRECTIONS —

— SPECIAL BUSH AND GUIDE PLATE ALLOW EASY ROTATION —

— 100% MAGNETIC CRACK TESTED —

WARNING: THESE RINGS DO NOT SWIVEL UNDER LOAD

LIFTING RINGS

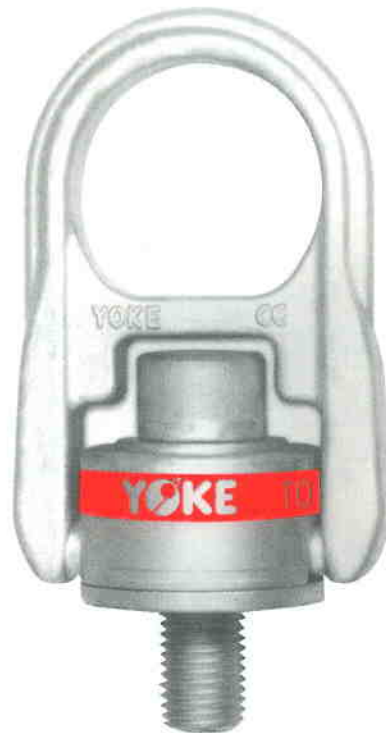

Size (thread dia.) mm	Thread length mm	Inside eye dia. mm	Material dia. (eye) mm	Safe working load kg	Approx weight kg
10	26	41	9	450	0,44
12	29	59	15	1050	2,10
16	34	59	15	1900	2,10
20	45	73	22	3000	4,20
24	50	73	22	4200	4,20
30	77	80	19	7000	6,77
36	75	109	25	11 000	16,00
42	90	109	30	12 500	16,00
48	105	109	30	13 500	17,00

— 5:1 SAFETY FACTOR —

— CAPABLE OF FULL WORKING LOAD IN ALL DIRECTIONS —

— 100% MAGNAFLUX CRACK DETECTION TESTED —

— SELF ALIGNS IN THE DIRECTION OF THE LOAD —

— 10mm TO 24mm WITH BALL BEARING ALLOWS FULL SWIVEL UNDER LOAD —

LASHING EQUIPMENT



BINDER CHAIN

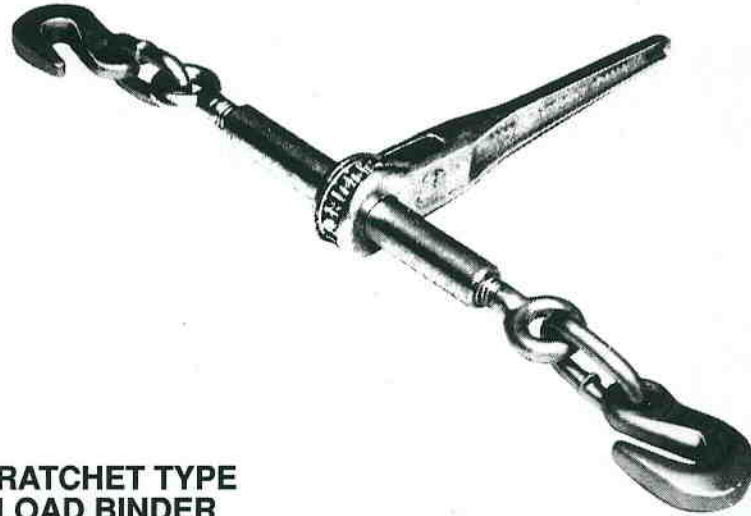

RATCHET TYPE
LOAD BINDER

LEVER TYPE
LOAD BINDER

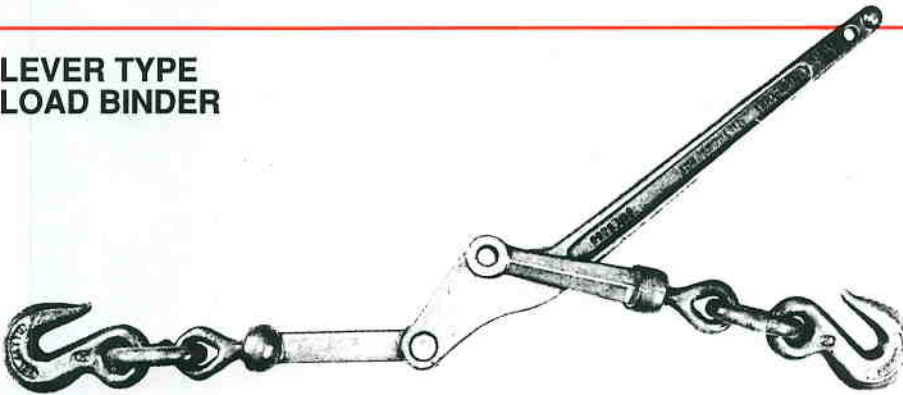

GRAB HOOK

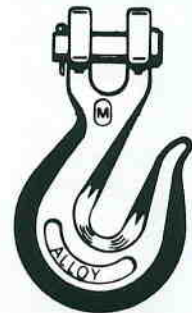

SLIP HOOK

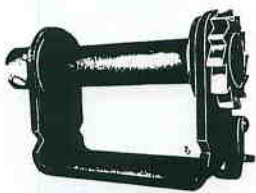

TRUCK WINCH



LASHING TURNBUCKLE



WELD-ON
TRANSPORT RING

RATCHET TENSIONER
COMPLETE WITH STRAPPING

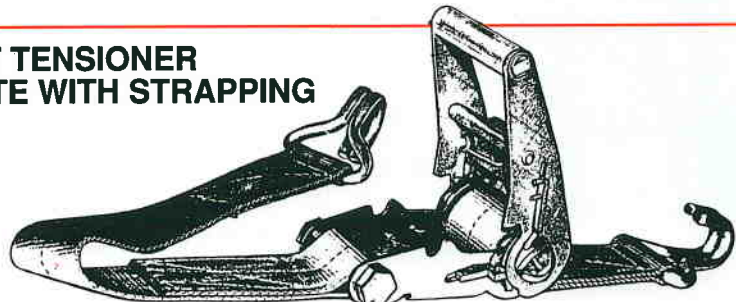



CHAIN

*** MILD STEEL
CHAIN
to Grade 30
for general purposes**

*** HIGHER TENSILE
CHAIN
to Grade 43
for load-binding
and general purposes**

*** STAINLESS
STEEL CHAIN
to AISI 316
for rust problem
applications
and general purposes**

For lifting purposes, use only Grade 80 chain

TURNBUCKLES

DROP-FORGED TO DIN 1480



EYE AND EYE



HOOK AND EYE



HOOK AND HOOK

Thread diameter mm	Body length mm	Approx. take-up mm	Eye inside diameter mm	Hook throat opening mm	Overall closed length mm	Overall open length mm	Safe working load kg	Approx. weight kg
6	110	85	8	8	170	250	220	0,10
8	110	80	10	10	180	260	410	0,17
10	125	85	12	12	210	300	660	0,29
12	125	80	17	15	225	320	940	0,45
14	140	92	17	18	265	355	1320	0,61
16	170	115	19	20	305	420	1800	0,95
20	200	130	24	22	360	480	2750	1,85
22	220	145	28	24	400	545	3300	2,20
24	250	170	28	28	440	610	4000	3,15
30	250	170	30	29	480	640	6620	5,25
36	290	180	48	29	550	720	9280	8,00
42	330	205	48	46	675	870	13200	13,00
48	350	200	55	55	730	900	16800	25,00

S.W.L. applies to eye and eye only. Others = 33 1/3% of S.W.L.

**DROP-FORGED TO DIN 1480
WITH WELDABLE ENDS**



AVAILABLE IN 6, 8, 10, 12, 14, 16, 20, 22, 24, 30 and 36 mm THREAD SIZES

DIE CAST

EYE AND EYE

HOOK AND EYE

HOOK AND HOOK

Thread diameter mm	Body length mm	Approx. take-up mm	Eye inside diameter mm	Hook throat opening mm	Overall closed length mm	Overall open length mm	Approx. weight kg
4	45	34	7	7	83	117	0,03
5	70	50	8	7	110	160	0,04
6	100	70	10	8	156	226	0,07
8	110	80	11	9	180	260	0,15
10	120	89	16	13	204	293	0,25
12	130	89	18	17	240	329	0,36

STAINLESS STEEL

EYE AND EYE

HOOK AND EYE

HOOK AND HOOK

AVAILABLE IN 5, 6, 8, 10, 12 and 16 mm THREAD SIZES

RIGGING SCREWS

DROP-FORGED CLOSED BODY WITH LOCK-NUTS



OVAL EYE AND EYE



OVAL EYE AND JAW



JAW AND JAW

Thread diameter mm*	Body length mm	Approx. take-up mm	Eye inside length mm	Eye inside width mm	Jaw inside length mm	Jaw inside width mm	Eye material diameter mm	Jaw pin diameter mm	Overall closed length mm	Overall open length mm	Safe working load kg	Approx. weight kg
10	123	80	13	13	21	10	8	8	235	315	500	0,28
12	193	130	29	14	25	12	11	10	330	462	700	0,66
16	230	140	40	16	32	17	15	10	410	550	1200	1,20
20	230	140	50	21	37	19	17	16	440	580	1500	2,15
22	295	215	50	23	43	24	17	20	535	750	2200	3,30
24	350	240	55	24	52	28	17	22	610	850	3200	5,20
32	370	260	64	30	62	31	20	26	700	960	4800	9,35
38	410	280	64	35	70	36	22	32	740	1020	6000	11,20
51	420	310	100	44	100	53	38	42	800	1110	10000	22,00
64	800	640	160	75	105	80	50	57	1410	2050	27200	73,00

*Please note: threads may be Imperial size. Metric equivalents stated for convenience.
: above measurements may be subject to commercial tolerances.

DROP-FORGED EXTRA-LONG OPEN BODY



JAW AND JAW

AVAILABLE IN 6, 8, 10, 12, 16, 20 and 24 mm THREAD SIZES

STAINLESS STEEL



JAW AND JAW

AVAILABLE IN 6, 8, 10, 12 and 16 mm THREAD SIZES

DROP-FORGED EYEBOLTS

to British Standard Specifications
(Ungalvanised)



WITH METRIC THREADS TO BSS 4278 TABLE 1

Thread diameter mm	Safe working load at 0° kg	Inside eye diameter mm	Eye material diameter mm	Shank length mm	Thread length mm	Approx weight kg
6	100	15	9	21	17	0,07
8	150	14	9	18	13	0,08
10	330	15	9	19	15	0,08
12	400	15	9	19	15	0,12
14	500	20	12	22	17	0,15
16	800	20	12	22	17	0,16
18	1000	24	15	29	24	0,28
20	1600	27	16	31	24	0,45
22	1600	28	16	32	24	0,54
24	2500	35	21	40	34	0,84
27	2500	37	22	44	37	1,25
30	4000	43	26	50	40	1,71
33	4000	44	28	52	44	2,88
36	6300	54	32	65	57	3,17
39	6300	55	34	70	60	5,04
42	8000	60	36	75	64	6,24
45	8000	65	40	80	68	7,16
48	10000	65	40	80	68	7,60
52	12500	73	48	88	75	10,18
56	16000	82	51	108	93	15,22
64	20000	90	57	115	100	19,50
72	25000	113	68	137	110	30
76	25000	115	68	137	110	30

WITH BSW THREADS TO BSS 529 PART 1

Thread diameter ins	Safe working load at 0° kg	Inside eye diameter mm	Eye material diameter mm	Shank length mm	Thread length mm	Approx weight kg
3/8	250	14	9	17	14	0,06
1/2	500	19	11	25	20	0,07
5/8	900	24	14	30	23	0,14
3/4	1400	28	17	34	27	0,28
7/8	2000	33	20	41	31	0,60
1	2750	38	22	44	36	1,10
1-1/8	3500	44	26	53	46	1,60
1-1/4	4500	47	30	59	49	2,10
1-1/2	6500	54	34	70	59	3,60
1-3/4	9000	66	39	82	68	5,60
2	12000	72	47	93	78	9,10
2-1/4	15000	82	54	100	88	15,00
2-1/2	20000	92	58	112	98	17,70

BRITISH STANDARD EYEBOLTS MAY BE USED TO LIFT INCLINED LOADS. THE SAFE WORKING LOAD PER EYEBOLT WILL BE REDUCED BY APPROXIMATELY 65% FOR ANGLES OF 30° AND APPROXIMATELY 75% FOR ANGLES OF 45°.

DROP-FORGED EYEBOLTS to DIN 580 (Galvanised)



Thread diameter mm	Safe working load at 0 kg	Inside eye diameter mm	Eye material diameter mm	Shank length mm	Thread length mm	Approx weight kg
6	70	15	6	11	9	0,05
8	140	19	8	12	9	0,06
10	230	24	10	16	14	0,11
12	340	29	11	20	17	0,18
14	490	34	14	26	22	0,28
16	700	34	14	27	22	0,32
18	900	40	16	29	25	0,45
20	1200	39	16	30	25	0,45
22	1500	44	19	32	28	0,67
24	1800	49	20	36	30	0,87
30	3200	59	25	46	38	1,66
33	4300	59	25	46	38	2,16
36	4600	70	27	60	51	2,65
42	6300	80	31	65	58	4,03
45	8000	89	38	67	57	6,00
48	8600	90	40	70	60	6,38
56	11500	109	47	83	70	8,80
64	16000	109	47	90	75	12,40
72	21000	138	62	100	86	20,80

DROP-FORGED EYENUTS to DIN 582 (Galvanised)



Thread diameter mm	Safe working load at 0 kg	Inside eye diameter mm	Eye material diameter mm	Shank length mm	Thread length mm	Approx weight kg
6	70	15	6	11	9	0,05
8	140	19	8	12	9	0,06
10	230	24	10	16	14	0,11
12	340	29	11	20	17	0,18
14	490	34	14	26	22	0,28
16	700	34	14	27	22	0,32
18	900	40	16	29	25	0,45
20	1200	39	16	30	25	0,45
22	1500	44	19	32	28	0,67
24	1800	49	20	36	30	0,87
30	3200	59	25	46	38	1,66
33	4300	59	25	46	38	2,16
36	4600	70	27	60	51	2,65
42	6300	80	31	65	58	4,03
45	8000	89	38	67	57	6,00
48	8600	90	40	70	60	6,38
56	11500	109	47	83	70	8,80
64	16000	109	47	90	75	12,40
72	21000	138	62	100	86	20,80

STAINLESS STEEL EYEBOLTS AND EYENUTS

AVAILABLE IN

6, 8, 10, 12, 14, 16, 20, 22 AND 24mm THREAD SIZES



ALLOY PIN DEE AND BOW SHACKLES

to U.S. Federal Specification RR-C-271b



DEE AND BOW WITH SCREW PIN

DEE AND BOW WITH BOLT, NUT, SPLIT PIN

Dee & Bow SWL short tons*	Dee & Bow body dia mm	Dee & Bow pin dia mm	Dee & Bow inside width at pin mm	Bow only inside width at bow mm	Dee only inside length mm	Bow only inside length mm	Dee only approx. weight kg	Bow only approx. weight kg
0,5	6	8	12	19	23	27	0,05	0,05
0,75	8	10	13	21	20	31	0,08	0,10
1	10	11	17	26	33	37	0,11	0,14
1,5	11	13	18	29	37	44	0,18	0,19
2	13	16	20	33	46	48	0,27	0,29
3,25	16	20	27	43	52	61	0,55	0,63
4,75	20	22	30	51	61	71	1,02	1,06
6,5	22	25	36	58	76	84	1,43	1,53
8,5	25	28	44	67	83	95	2,16	2,42
9,5	28	32	47	73	91	107	3,06	3,09
12	32	35	52	81	101	119	4,11	4,31
13,5	35	38	58	91	118	134	5,28	6,02
17	38	42	61	98	125	144	7,24	8,04
25	44	51	74	126	150	180	12	14
35	51	56	85	143	170	197	19	21
55	64	70	105	184	203	267	33	39
85	76	85	128	215	215	315	56	70
120	89	95	133	230	240	365	98	120
150	102	108	141	250	-	375	-	140

* One short ton = 0,907 metric tons

LARGE DEE SHACKLES

to British Standard Specification 3032

SWL Metric tons	Body diameter mm	Pin diameter mm	Inside width mm	Inside length mm	Approx. weight kg
0,5	10	12	19	38	0,17
0,75	13	16	25	46	0,35
1,5	16	19	32	68	0,66
2	19	22	38	73	1,02
3	22	24	44	80	1,57
3,75	25	28	50	94	2,3
5	28	32	55	101	3,2
6	32	36	61	112	4,3
7	35	38	67	127	5,4
9,5	38	44	70	137	6,8
13	44	51	83	156	11,0
16,25	51	57	98	187	20,0
20	57	64	110	210	26,8

LARGE DEE SHACKLES ARE ALSO AVAILABLE UNGALVANISED

CARBON STEEL HOOKS



EYE TYPE



SWIVEL TYPE



SHANK TYPE

SWL metric tons	Throat opening (all) mm	Inside dia of eye mm	Overall length of eye hook mm	Inside length of swivel mm	Inside width of swivel mm	Overall length of swivel hook mm	Dia of shank mm	Length of shank mm	Overall length of shank hook mm
0,75	20	19	109	23	30	140	15	50	128
1	22	22	128	32	37	167	16	56	140
1,5	25	28	142	39	43	189	18	64	157
2	26	31	163	39	43	207	22	67	176
3	32	39	200	45	50	245	29	81	210
5	37	50	260	59	62	320	36	94	260
7,5	47	61	320	67	78	385	43	108	315
10	47	61	320	67	78	385	43	108	315
15	54	71	360	-	-	-	-	-	-



SLIDING CHOKER HOOKS



CARABINE HOOKS
(electro-galvanised and stainless steel)

SOCKETS • THIMBLES • FERRULES



OPEN
SPELTER
SOCKETS
TO BSS 463



CLOSED
SPELTER
SOCKETS
TO BSS 463



WEDGE
SOCKETS



SELF-COLOUR
SOLID THIMBLES
TO BSS 464



GALVANISED
HEAVY DUTY
THIMBLES
TO BSS 464



GALVANISED
REEVING THIMBLES
TO BSS 464



GALVANISED
AND STAINLESS
STEEL THIMBLES
TO G-411



ALUMINIUM
FERRULES
TO DIN 3093



STEEL
FERRULES



COPPER
FERRULES

ROPE CLAMPS • SHACKLES



GALVANISED
DROP-FORGED
ROPE CLAMPS
TO FFC-450



GALVANISED
MALLEABLE CAST
ROPE CLAMPS
(BULLDOG TYPE)
TO FFC-450



GALVANISED AND
STAINLESS STEEL
MALLEABLE CAST
ROPE CLAMPS
(COMMERCIAL TYPE)
TO DIN741



GALVANISED, STAINLESS STEEL
AND EXTRA LONG STAINLESS STEEL
COMMERCIAL DEE SHACKLES



GALVANISED AND STAINLESS STEEL
COMMERCIAL BOW SHACKLES

**COMMERCIAL SHACKLES ARE NOT SUITABLE
FOR LIFTING APPLICATIONS**

ROPE CUTTERS



MODEL WR-10 CUTS UP TO 10mm ROPE
MODEL WR-16 CUTS UP TO 16mm ROPE



MODEL RC-8 CUTS UP TO 5mm ROPE



SPARE BLADE KITS

ROPE SWAGERS



MODEL HSC-350 SWAGES 2mm TO 3,5mm ROPE
MODEL HSC-600 SWAGES 2mm TO 5mm ROPE



MODEL HSC-600BB SWAGES 2mm TO 5mm ROPE
SUITABLE FOR LARGER VOLUMES

LEVER PULLERS



AVAILABLE IN 2 TON AND 4 TON CAPACITIES
NOT TO BE USED FOR LIFTING

WIRE GRIPS

0.5t MINI-GRIP
• 1 to 9,5mm



1t SD GRIP WITH SAFETY LATCH
• 2,6 to 15mm (SMALL AND LARGE EYE)

2,3t GRIP
• 3,2 to 12,7mm
(LARGE EYE)



2t GRIP WITH SAFETY LATCH
• 4 to 22mm (LARGE EYE)

ALSO AVAILABLE FOR BARE
ALUMINIUM CONDUCTOR
4 to 22mm (LARGE EYE)

3t GRIP WITH SAFETY LATCH
• 8 to 22mm
(LARGE EYE)
• 16 to 32mm
(LARGE EYE)



ALSO AVAILABLE
FOR BARE ALUMINIUM
CONDUCTOR 16 to 32mm
(LARGE EYE)

4t GRIP
WITH SAFETY LATCH
• 13 to 28mm (SMALL EYE)
• 20 to 35mm (LARGE EYE)



ALSO AVAILABLE FOR
BARE ALUMINIUM
CONDUCTOR
18 to 35mm (LARGE EYE)

THRUST BEARING SWIVELS



EYE AND EYE



EYE AND JAW



HOOK AND EYE

Type	Safe working load kg	Total length mm	Outside body dia mm	Eye dia mm	Pin dia mm	Jaw Opening mm
E-E	3 000	270	77	20	-	-
H-E	3 000	325	77	20	-	-
E-J	3 000	280	77	20	20	22
E-E	5 000	275	95	32	-	-
H-E	5 000	380	95	32	-	-
E-J	5 000	300	95	32	23	27
E-E	7 500	315	100	35	-	-
H-E	7 500	440	100	35	-	-
E-J	7 500	335	100	35	30	36
E-E	10 000	385	122	40	-	-
H-E	10 000	525	122	40	-	-
E-J	10 000	405	122	40	35	47

— FITTED WITH GREASE NIPPLES FOR LUBRICATION
TO ENSURE LONG LIFE AND EASE OF OPERATION —
— THESE SWIVELS ARE USED FOR ROTATION UNDER LOAD —

FORGED SWIVELS

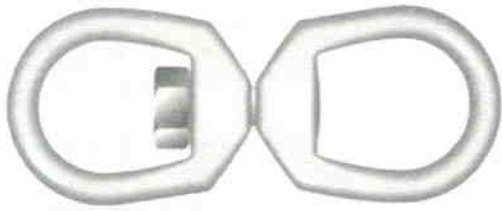

EYE AND EYE

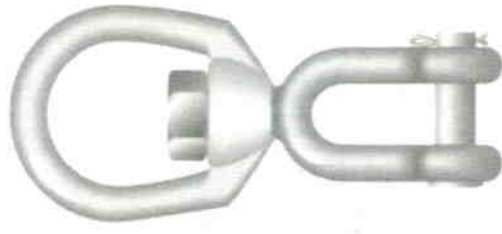

EYE AND JAW

Size (eye material) mm	Eye outside width mm	Eye inside width mm	Eye inside lengths mm	Eye-eye overall inside length mm	Jaw pin diameter mm	Jaw inside width mm	Jaw inside length mm	Eye-jaw overall inside length mm	Safe working load kg	Approx. weight kg
8	40	23	20/29	89	8	13	22	73	570	0,18
10	51	31	24/35	108	10	17	28	92	1020	0,32
12	62	35	32/46	137	12	21	34	115	1600	0,65
16	75	42	39/55	168	16	24	38	135	2400	1,12
20	88	49	43/64	185	20	30	45	154	3300	1,80
22	102	56	51/70	205	22	30	56	180	4500	2,80
24	113	60	55/82	240	28	45	72	220	5700	4,06
32	141	78	55/91	282	35	52	74	245	8000	7,44
38	183	101	115/155	445	50	76	114	380	20 000	24,89

— THESE SWIVELS ARE USED FOR POSITIONING ONLY —

— FOR ROTATION UNDER LOAD, THRUST BEARING SWIVELS SHOULD BE USED —

WIRE ROPE BLOCKS

WIRE ROPE SNATCH BLOCKS



WIRE ROPE REEVING BLOCKS

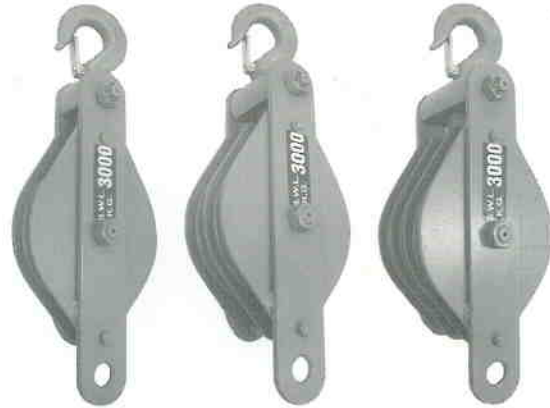

SWL (kg)	Sheave dia (mm)	Rope dia (mm)
500	100	10 - 13
1 000	125	10 - 13
2 000	150	10 - 13
3 000	200	13 - 16
5 000	250	16 - 20
7 500	300	16 - 20
10 000	350	20 - 22

- SNATCH BLOCKS AVAILABLE UP TO 40 TON CAPACITY FOR USE WITH 38mm DIAMETER STEEL WIRE ROPE —
- REEVING BLOCKS AVAILABLE IN EXCESS OF 100 TON CAPACITY —
- GREASE NIPPLES FOR POSITIVE LUBRICATION —
- AVAILABLE WITH FORGED STEEL HOOK, SWIVEL OVAL EYE, SWIVEL SAFETY SHACKLE, OR LINK AND SHACKLE —

MANILA ROPE BLOCKS

GIN BLOCKS



PULLEY BLOCKS



RUNNING OUT BLOCKS



- MANILA PULLEY BLOCKS AVAILABLE IN SINGLE, DOUBLE AND TREBLE SHEAVES FOR USE WITH 10mm TO 24mm DIAMETER NATURAL AND SYNTHETIC FIBRE ROPES —
- GIN BLOCKS AVAILABLE IN 200 kg, 300 kg AND 400 kg CAPACITIES —
- 1000 kg RUNNING OUT BLOCKS WITH NYLON SHEAVE WHEEL —

WIRE ROPE SHEAVE WHEELS



- 65mm TO 800mm DIAMETERS —
- FULLY MACHINED STEEL OR CAST IRON —
- PHOSPHOR BRONZE BUSHES —
- ROLLER OR BALL BEARINGS AVAILABLE —

HAND CHAIN WHEELS

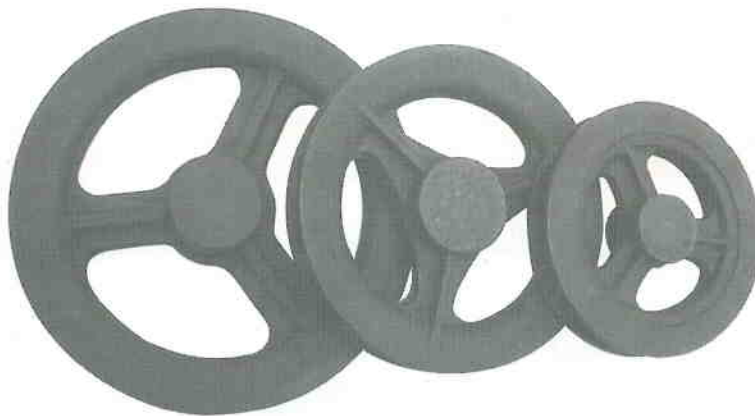

Wheel dia (mm)	Bore dia (mm)	Chain size (mm)
150	40	5
200	55	6
250	70	6
300	70	6
400	75	6
530	85	6